

Kenai Peninsula Borough
Planning Department

MEMORANDUM

TO: Peter Ribbens, Assembly President
Kenai Peninsula Borough Assembly Members

THRU: Samantha Lopez, Acting Planning Director *SL*

FROM: Madeleine Quinton, Assistant Planner *MQ*

DATE: March 18, 2025

RE: Application for New Liquor License; **Application:** Miller's Landing; **Landowner of New Premises:** Michael and Sherrie Miller Revocable Trust; **License #:** 16581; **Parcel #:** 189-201-18; **Property Description:** T 1S R 1W SEC 22 SEWARD MERIDIAN SW 2001018 DEACON SUB BEACH DRIVE REPLAT LOT 1A BLK 1, Lowell Point, Alaska.

As requested, the Planning Department has reviewed the above application for a new liquor license that will be operated from 13880 Beach Drive, Lowell Point, to determine if there are any churches or schools within 500 feet (KPB 7.10).

A radius search identified no churches or schools within 500-feet of KPB Parcel #189-201-18, 13880 Beach Drive, Lowell Point, AK.

The property complies with all the requirements of KPB 7.10.020(A)(2)(a-e).

Please see the attached Planning Review map for reference.



Miller's Landing



Application Number: 16581

KPB Parcel ID: 18920118

Imagery Map



LEGEND

-  Parcel Boundary
-  License Site (If Known)

Vicinity: Remote



Thursday, February 13, 2025

*Radius shown depicts the radius from the outline of the building that will contain the establishment or the parcel boundary if the building footprint is unavailable or unknown. KPB 7.30 states that the distance must be measured by the shortest pedestrian route. If there are institutional parcels located within 500ft, the shortest pedestrian path will be measured. Questions or comments can be relayed to mquinton@kpb.us.

The data displayed herein is neither a legally recorded map nor survey and should only be used for general reference purposes. It is not intended to be used for measurement. Kenai Peninsula Borough assumes no liability as to the accuracy of any data displayed herein. Original source documents should be consulted for accuracy verification.



Miller's Landing

Application Number: 16581

KPB Parcel ID: 18920118

Land Use Map

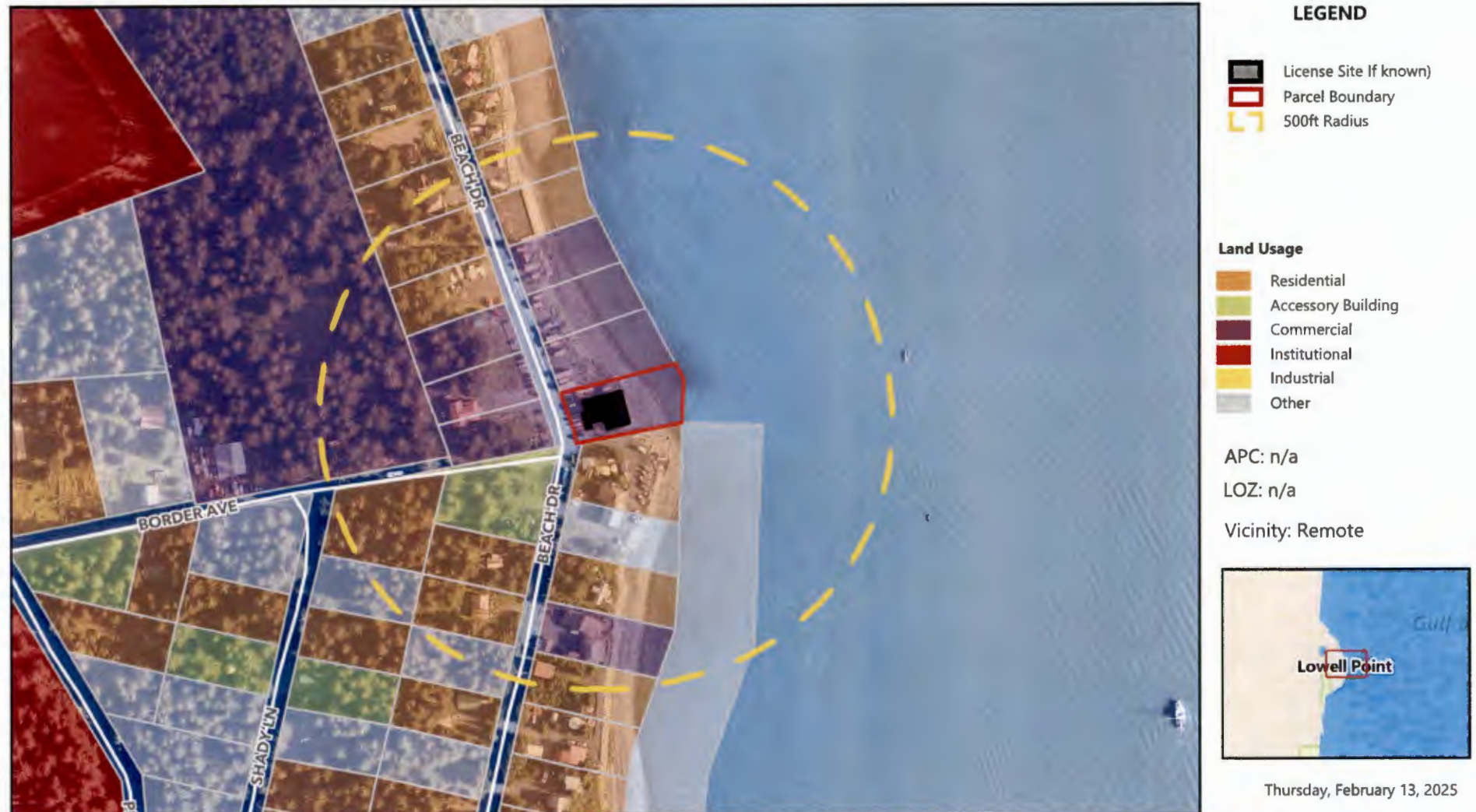

*Radius shown depicts the radius from the outline of the building that will contain the establishment or the parcel boundary if the building footprint is unavailable or unknown. KPB 7.30 states that the distance must be measured by the shortest pedestrian route. If there are institutional parcels located within 500ft, the shortest pedestrian path will be measured. Questions or comments can be relayed to mquainton@kpb.us.