



March 17, 2017

Kenai Peninsula Borough
Attn: Johni Blankenship
VIA Email: jblankenship@kpb.us
CC: micheleturner@kpb.us

License Number:	10876
License Type:	Limited Marijuana Cultivation Facility
Licensee:	JOEL H ZEBILL
Doing Business As:	HALE HARVEST
Physical Address:	18132 Loveall Loop Clam Gulch, AK 99568
Designated Licensee:	JOEL H ZEBILL
Phone Number:	605-651-3029
Email Address:	joel_zebill@yahoo.com

- New Application** **Transfer of Ownership Application** **Renewal Application**
 Onsite Consumption Endorsement

AMCO has received a completed application for the above listed license (see attached application documents) within your jurisdiction. This is the notice required under 3 AAC 306.025(d)(2).

To protest the approval of this application(s) pursuant to 3 AAC 306.060, you must furnish the director **and** the applicant with a clear and concise written statement of reasons for the protest within 60 days of the date of this notice, and provide AMCO proof of service of the protest upon the applicant.

3 AAC 306.010, 3 AAC 306.080, and 3 AAC 306.250 provide that the board will deny an application for a new license if the board finds that the license is prohibited under AS 17.38 as a result of an ordinance or election conducted under AS 17.38 and 3 AAC 306.200, or when a local government protests an application on the grounds that the proposed licensed premises are located in a place within the local government where a local zoning ordinance prohibits the marijuana establishment, unless the local government has approved a variance from the local ordinance.

This application will be in front of the Marijuana Control Board at our **April 4-5, 2017** meeting.

Sincerely,

Sara Chambers, Interim Director
amco.localgovernmentonly@alaska.gov

Alaska Department of Commerce, Community, and Economic Development

Division of Corporations, Business and Professional Licensing
P.O. Box 110806, Juneau, Alaska 99811-0806

This is to certify that

HALE HARVEST

PO BOX 3625 SOLDOTNA AK 99669

owned by

JOEL H ZEBILL

is licensed by the department to conduct business for the period

June 20, 2016 through December 31, 2017
for the following line of business:

11 - Agriculture, Forestry, Fishing and Hunting

This license shall not be taken as permission to do business in the state without having complied with the other requirements of the laws of the State or of the United States.

This license must be posted in a conspicuous place at the business location.
It is not transferable or assignable.

Chris Hladick
Commissioner





Alaska Marijuana Control Board Form MJ-00: Application Certifications

What is this form?

This application certifications form is required for all marijuana establishment license applications. Each person signing an application for a marijuana establishment license must declare that he/she has read and is familiar with AS 17.38 and 3 AAC 306.

This form must be completed and submitted to AMCO's main office **by each proposed licensee** (as defined in 3 AAC 306.020(b)(2)) before any license application will be considered complete.

Section 1 – Establishment Information

Enter information for the business seeking to be licensed, as identified on the license application.

Licensee:	Joel Zebill	License Number:	10876
License Type:	Limited Marijuana Cultivation Facility		
Doing Business As:	Hale Harvest		
Premises Address:	18132 Loveall Loop		
City:	Clam Gulch	State:	AK
		ZIP:	99568

Section 2 – Individual Information

Enter information for the individual licensee or affiliate.

Name:	Joel Zebill
Title:	Owner

Section 3 – Other Licenses

Ownership and financial interest in other licenses: Yes No

Do you currently have or plan to have an ownership interest in, or a direct or indirect financial interest in another marijuana establishment license?

If "Yes", which license numbers (for existing licenses) and license types do you own or plan to own?



Alaska Marijuana Control Board Form MJ-00: Application Certifications

Section 4 – Certifications

Read each line below, and then sign your initials in the box to the right of each statement:

Initials

I certify that I have not been convicted of a felony in any state or the United States, including a suspended imposition of sentence, for which less than five years have elapsed from the time of the conviction to the date of this application.

JZ

I certify that I am not currently on felony probation or felony parole.

JZ

I certify that I have not been found guilty of selling alcohol without a license in violation of AS 04.11.010.

JZ

I certify that I have not been found guilty of selling alcohol to an individual under 21 years of age in violation of 04.16.051 or AS 04.16.052.

JZ

I certify that I have not been convicted of a misdemeanor crime involving a controlled substance, violence against a person, use of a weapon, or dishonesty within the five years preceding this application.

JZ

I certify that I have not been convicted of a class A misdemeanor relating to selling, furnishing, or distributing marijuana or operating an establishment where marijuana is consumed within the two years preceding this application.

JZ

I certify that my proposed premises is not within 500 feet of a school ground, recreation or youth center, a building in which religious services are regularly conducted, or a correctional facility, as set forth in 3 AAC 306.010(a).

JZ

I certify that my proposed premises is not located in a liquor licensed premises.

JZ

I certify that I meet the residency requirement under AS 43.23 for a permanent fund dividend in the calendar year in which I am initiating this application.

JZ

I certify that all proposed licensees (as defined in 3 AAC 306.020(b)(2)) and affiliates (as defined in 3 AAC 306.990(a)(1)) have been listed on my online marijuana establishment license application.

JZ

I certify that all proposed licensees have been listed on my application with the Division of Corporations.

JZ

I certify that I understand that providing a false statement on this form, the online application, or any other form provided by AMCO is grounds for denial of my application.

JZ



Alaska Marijuana Control Board Form MJ-00: Application Certifications

Read each line below, and then sign your initials in the box to the right of only the applicable statement:

Initials

Only initial next to the following statement if this form is accompanying an application for a marijuana testing facility license:

I certify that I do not have an ownership in, or a direct or indirect financial interest in a retail marijuana store, a marijuana cultivation facility, or a marijuana products manufacturing facility.

Only initial next to the following statement if this form is accompanying an application for a retail marijuana store, a marijuana cultivation facility, or a marijuana products manufacturing facility license:

I certify that I do not have an ownership in, or a direct or indirect financial interest in a marijuana testing facility license.

III marijuana establishment license applicants:

As an applicant for a marijuana establishment license, I declare under penalty of unsworn falsification that I have read and am familiar with AS 17.38 and 3 AAC 306, and that I have examined the online application and this form, including all accompanying schedules and statements, and to the best of my knowledge and belief find them to be true, correct, and complete.

Signature of licensee

Joel Zebell

Printed name

Subscribed and sworn to before me this 30th day of August, 2016.



Notary Public in and for the State of Alaska.

My commission expires: July 15, 2017



Alaska Marijuana Control Board

Form MJ-01: Marijuana Establishment Operating Plan

What is this form?

An operating plan is required for all marijuana establishment license applications. Applicants should review **Title 17.38 of Alaska Statutes** and **Chapter 306 of the Alaska Administrative Code**. This form will be used to document how an applicant intends to meet the requirements of those statutes and regulations. If your business has a formal operating plan, you may include a copy of that operating plan with your application, but all fields of this form must still be completed per 3 AAC 306.020(c).

What must be covered in an operating plan?

Applicants must identify how the proposed premises will comply with applicable statutes and regulations regarding the following:

- Security
- Inventory tracking of all marijuana and marijuana product on the premises
- Employee qualification and training
- Waste disposal
- Transportation and delivery of marijuana and marijuana products
- Signage and advertising
- Control plan for persons under the age of 21

Applicants must also complete the corresponding operating plan supplemental forms (**Form MJ-03, Form MJ-04, Form MJ-05, or Form MJ-06**) to meet the additional operating plan requirements for each license type.

Section 1 – Establishment Information

Enter information for the business seeking to be licensed, as identified on the license application.

Licensee:	Joel Zebill	License Number:	10876		
License Type:	Limited Marijuana Cultivation Facility				
Doing Business As:	Hale Harvest				
Premises Address:	18132 Loveall Loop				
City:	Clam Gulch	State:	ALASKA	ZIP:	99568

Mailing Address:	PO Box 3625				
City:	Soldotna	State:	ALASKA	ZIP:	99669

Primary Contact:	Joel Zebill				
Main Phone:	(907) 260-9070	Cell Phone:	(605) 651-3029		
Email:	haleharvest@gmail.com				



Alaska Marijuana Control Board

Form MJ-01: Marijuana Establishment Operating Plan

Section 2 – Security

Review the requirements under 3 AAC 306.710 – 3 AAC 306.720 and 3 AAC 306.755, and identify how the proposed premises will meet the listed requirements.

Describe how the proposed premises will comply with each of the following:

Restricted Access Areas (3 AAC 306.710):

Describe how you will prevent unescorted members of the public from entering restricted access areas:

The exterior door to the facility will automatically lock. All codes and keys will only remain in possession of authorized personnel. Any visitor will be required to wear a visible visitor ID badge and will be escorted at all times.

Describe your processes for admitting visitors into and escorting them through restricted access areas:

All visitors will be met, identified, age verified, and issued and ID badge upon arrival. All visitors will be required to remain with authorized personnel while in restricted areas. No personnel will escort more than 5 visitors at any time.



Alaska Marijuana Control Board

Form MJ-01: Marijuana Establishment Operating Plan

Describe your recordkeeping of visitors who are escorted into restricted access areas:

All visitors will be required to sign in and sign out, recording current date, time of arrival, and time of departure. Surveillance cameras will record all visitor activity with timestamp data in the video.

Provide a copy of a sample identification badge to be displayed by each licensee, employee, or agent while on the premises:





Alaska Marijuana Control Board

Form MJ-01: Marijuana Establishment Operating Plan

Security Alarm Systems and Lock Standards (3 AAC 306.715):

Exterior lighting is required to facilitate surveillance. Describe how the exterior lighting will meet this requirement:

A motion sensor light will be pointed at the road entrance. One light over the facility entrance will remain on in low light conditions. All lit areas will be bright enough to identify vehicles and persons arriving at the facility.

An alarm system is required for all license types. Describe the security alarm system for the proposed premises:

The security system will detect motion in the driveway and at the entrance and will alert occupants to activity. The owner will also be living adjacent to the facility.

The alarm system must be activated on all exterior doors and windows when the licensed premises is closed for business. Describe how the security alarm system meets this requirement:

There is a single entrance access and no windows in the facility. The motion sensitive camera system and door trigger will alert authorized personnel via SMS alert and have a remotely viewable camera feed.



Alaska Marijuana Control Board

Form MJ-01: Marijuana Establishment Operating Plan

12

All plants and products will be tracked with the METRC inventory system. All processing of marijuana plants and products will be performed under video surveillance. All product leaving the facility will be in a sealed container with the weight written on the outside and be properly inventoried with the METRC system. All marijuana sold will be sold only to authorized marijuana retailers or processing facilities. Any theft, including by employees, will be immediately reported to authorities. Hale Harvest will strictly adhere to all relevant state statutes and regulations in regards to storage, transport, and sale of marijuana or marijuana products.

Describe your policies and procedures for preventing loitering:

This is a cultivation facility residing on private property. Any unauthorized persons will be immediately asked to leave.

Describe your policies and procedures regarding the use of any additional security device, such as a motion detector, pressure switch, and duress, panic, or hold-up alarm to enhance security of the proposed premises:

All camera feeds will be viewable inside the facility with a dedicated monitor, at the owner's residence, and remotely by authorized personnel. The camera feeds will alert personnel to motion and the door alarm will alert personnel when not present. All personnel will have cell phones on premises to contact authorities.



Alaska Marijuana Control Board

Form MJ-01: Marijuana Establishment Operating Plan

Describe your policies and procedures regarding the actions to be taken by a licensee, employee, or agent when any automatic or electronic notification system alerts a local law enforcement agency of an unauthorized breach of security:

The surveillance system will automatically alert authorized personnel to activity when no one is present at the facility. That activity can be viewed and law enforcement will be contacted by personnel and will immediately return to the facility as soon as possible.

Video Surveillance (3 AAC 306.720):

All licensed marijuana establishments must meet minimum standards for surveillance equipment. Applicants should be able to answer "Yes" to all items below.

Video surveillance and camera recording system covers the following areas of the premises:	Yes	No
Each restricted access area and each entrance to a restricted access area	<input checked="" type="checkbox"/>	<input type="checkbox"/>
Both the interior and exterior of each entrance to the facility	<input checked="" type="checkbox"/>	<input type="checkbox"/>
Each point of sale area	<input checked="" type="checkbox"/>	<input type="checkbox"/>
Each video surveillance recording:	Yes	No
Is preserved for a minimum of 40 days, in a format that can be easily accessed for viewing	<input checked="" type="checkbox"/>	<input type="checkbox"/>
Clearly and accurately displays the time and date	<input checked="" type="checkbox"/>	<input type="checkbox"/>
Is archived in a format that does not permit alteration of the recorded image, so that the images can readily be authenticated	<input checked="" type="checkbox"/>	<input type="checkbox"/>



Alaska Marijuana Control Board

Form MJ-01: Marijuana Establishment Operating Plan

Describe how the video cameras will be placed to produce a clear view adequate to identify any individual inside the licensed premises, or within 20 feet of each entrance to the licensed premises:

There will be a high definition camera placed with a view and in close proximity of the interior and exterior of the entrance. There will be cameras viewing all interior areas of the facility of sufficient quality to identify individuals.

Describe the locked and secure area where video surveillance recording equipment and records will be housed and stored and how you will ensure the area is accessible only to authorized personnel, law enforcement, or an agent of the board:

The server will be locked within a secure cabinet within the facility in an area only accessible by authorized personnel. Law enforcement or an agent of the board will be given access upon arrival by request.

Location of Surveillance Equipment and Video Surveillance Records:

Yes No

Surveillance room or area is clearly defined on the premises diagram

Surveillance recording equipment and video surveillance records are housed in a designated, locked, and secure area or in a lock box, cabinet, closet or other secure area

Surveillance recording equipment access is limited to a marijuana establishment licensee or authorized employee, and to law enforcement personnel including an agent of the board

Video surveillance records are stored off-site



Alaska Marijuana Control Board

Form MJ-01: Marijuana Establishment Operating Plan

Business Records (3 AAC 306.755):

All licensed marijuana establishments must maintain, in a format that is readily understood by a reasonably prudent business person, certain business records. Applicants should be able to answer "Yes" to all items below.

Business Records Maintained and Kept on the Licensed Premises:

Yes

No

All books and records necessary to fully account for each business transaction conducted under its license for the current year and three preceding calendar years; records for the last six months are maintained on the marijuana establishment's licensed premises; older records may be archived on or off-premises

A current employee list setting out the full name and marijuana handler permit number of each licensee, employee, and agent who works at the marijuana establishment

The business contact information for vendors that maintain video surveillance systems and security alarm systems for the licensed premises

Records related to advertising and marketing

A current diagram of the licensed premises including each restricted access area

A log recording the name, and date and time of entry of each visitor permitted into a restricted access area

All records normally retained for tax purposes

Accurate and comprehensive inventory tracking records that account for all marijuana inventory activity from seed or immature plant stage until the retail marijuana or retail marijuana product is sold to a consumer, to another marijuana establishment, or destroyed

Transportation records for marijuana and marijuana product as required under 3 AAC 306.750(f)



Alaska Marijuana Control Board

Form MJ-01: Marijuana Establishment Operating Plan

A marijuana establishment is required to exercise due diligence in preserving and maintaining all required records.

Describe how you will prevent records and data, including electronically maintained records, from being lost or destroyed:

All paper records will be stored in a fire resistant, locked storage box. Video records and electronic data will be stored on a RAID (Redundant Array of Independent Discs) array or equal backup solution.



Alaska Marijuana Control Board

Form MJ-01: Marijuana Establishment Operating Plan

Section 3 – Inventory Tracking of All Marijuana and Marijuana Product

Review the requirements under 3 AAC 306.730, and identify how the proposed establishment will meet the listed requirements.

All licensed marijuana establishments must use a marijuana inventory tracking system capable of sharing information with the system the board implements to ensure all marijuana cultivated and sold in the state, and each marijuana product processed and sold in the state, is identified and tracked from the time the marijuana propagated from seed or cutting, through transfer to another licensed marijuana establishment, or use in manufacturing a product, to a completed sale of marijuana or marijuana product, or disposal of the harvest batch of marijuana or production lot of marijuana product.

Applicants should be able to answer “Yes” to all items below.

Marijuana Tracking and Weighing:

Yes No

A marijuana inventory tracking system, capable of sharing information with the system the board implements to ensure tracking for the reasons listed above, will be used

All marijuana delivered to a marijuana establishment will be weighed on a scale certified in compliance with 3 AAC 306.745

Describe the marijuana tracking system that you plan to use and how you will ensure that it is capable of sharing information with the system the board implements:

Hale Harvest will be using the METRC system implemented by the state of Alaska.



Alaska Marijuana Control Board

Form MJ-01: Marijuana Establishment Operating Plan

Section 4 – Employee Qualification and Training

Review the requirements under 3 AAC 306.700, and identify how the proposed establishment will meet the listed requirements.

A marijuana establishment and each licensee, employee, or agent of the marijuana establishment who sells, cultivates, manufactures, tests, or transports marijuana or a marijuana product, or who checks the identification of a consumer or visitor, shall obtain a marijuana handler permit from the board before being licensed or beginning employment at a marijuana establishment.

Applicants should be able to answer "Yes" to all items below.

Marijuana Handler Permit:

Yes No

Each licensee, employee, or agent of the marijuana establishment who sells, cultivates, manufactures, tests, or transports marijuana or marijuana product, or who checks the identification of a consumer or visitor, shall obtain a marijuana handler permit from the board before being licensed or beginning employment at the marijuana establishment

Each licensee, employee, or agent who is required to have a marijuana handler permit shall keep that person's marijuana handler permit card in that person's immediate possession (or a valid copy on file on the premises of a retail marijuana store, marijuana cultivation facility, or marijuana product manufacturing facility) when on the licensed premises

Each licensee, employee, or agent who is required to have a marijuana handler permit shall ensure that that person's marijuana handler permit card is valid and has not expired

Describe how your establishment will meet the requirements for employee qualifications and training:

All employees must undergo the marijuana handler permit training, and have a current, valid permit. All employees will be required to review policies regarding security and handling.



Alaska Marijuana Control Board

Form MJ-01: Marijuana Establishment Operating Plan

Section 5 – Waste Disposal

Review the requirements under 3 AAC 306.740, and identify how the proposed establishment will meet the listed requirements.

Applicants should be able to answer “Yes” to the statement below.

Marijuana Waste Disposal:

Yes

No

The marijuana establishment shall give the board at least 3 days notice in the marijuana inventory tracking system required under 3 AAC 306.730 before making the waste unusable and disposing of it

Describe how you will store, manage, and dispose of any solid or liquid waste, including wastewater generated during marijuana cultivation, production, process, testing, or retail sales, in compliance with applicable federal, state, and local laws and regulations:

Solid waste will be ground and composted for future use as soil. It may also be sold to a manufacturing facility if the market allows for it in the future. Wastewater will be drained into a drain field.

Describe what material or materials you will mix with the ground marijuana waste to make it unusable:

Solid waste will be mixed with soil, kitchen waste, and fish waste.



Alaska Marijuana Control Board

Form MJ-01: Marijuana Establishment Operating Plan

[Empty rectangular box]

Section 5 – Waste Disposal

Review the requirements under 3 AAC 306.740, and identify how the proposed establishment will meet the listed requirements.
req Applicants should be able to answer "Yes" to the statement below.

Marijuana Waste Disposal:

Yes No

The marijuana establishment shall give the board at least 3 days notice in the marijuana inventory system required under 3 AAC 306.730 before making the waste unusable and disposing of it

tracking

Describe how you will store, manage, and dispose of any solid or liquid waste, including wastewater generated during marijuana cultivation, production, process, testing, or retail sales, in compliance with applicable federal, state, and local laws and regulations:

12

Solid waste will be ground and composted for future use as soil. It may also be sold to a manufacturing facility if the market allows for it in the future. Wastewater will be drained into a drain field. All plant waste will be stored in labeled totes indicating the batch it is from. The waste will be stored in the labeled totes while the Marijuana Control board is notified of the intent to dispose. The waste will not be rendered unusable until at least three days after Board notification.

[Empty rectangular box]



Alaska Marijuana Control Board

Form MJ-01: Marijuana Establishment Operating Plan

[Empty rectangular box]

Describe what material or materials you will mix with the ground marijuana waste to make it unusable:

Solid waste will be mixed with soil, kitchen waste, and fish waste.

Marijuana waste must be rendered unusable for any purpose for which it was grown or produced before it leaves the marijuana establishment. Describe the process or processes that you will use to make the marijuana plant waste unusable:

12

Marijuana plant waste will be ground and composted for future use. The marijuana plant waste will be ground and then mixed with soil and fish and plant waste and composted in a tumbling composter. The composter will be located inside of the restricted access area. No waste will leave the restricted access area until it is unrecognizable and unusable as marijuana plant waste.



Alaska Marijuana Control Board

Form MJ-01: Marijuana Establishment Operating Plan

Section 6 – Transportation and Delivery of Marijuana and Marijuana Products

Review the requirements under 3 AAC 306.750, and identify how the proposed establishment will meet the listed requirements.

Applicants should be able to answer “Yes” to all items below.

Marijuana Transportation:

Yes No

The marijuana establishment from which a shipment of marijuana or marijuana product originates will ensure that any individual transporting marijuana shall have a marijuana handler permit required under 3 AAC 306.700

The marijuana establishment that originates the transport of any marijuana or marijuana product will use the marijuana inventory tracking system to record the type, amount, and weight of marijuana or marijuana product being transported, the name of the transporter, the time of departure and expected delivery, and the make, model, and license plate number of the transporting vehicle

The marijuana establishment that originates the transport of any marijuana or marijuana product will ensure that a complete printed transport manifest on a form prescribed by the board must be kept with the marijuana or marijuana product at all times during transport

During transport, any marijuana or marijuana product will be in a sealed package or container in a locked, safe, and secure storage compartment in the vehicle transporting the marijuana or marijuana product, and the sealed package will not be opened during transport

Any vehicle transporting marijuana or marijuana product will travel directly from the shipping marijuana establishment to the receiving marijuana establishment, and will not make any unnecessary stops in between except to deliver or pick up marijuana or marijuana product at any other licensed marijuana establishment

When the marijuana establishment receives marijuana or marijuana product from another licensed marijuana establishment, the recipient of the shipment will use the marijuana inventory tracking system to report the type, amount, and weight of marijuana or marijuana product received

The marijuana establishment will refuse to accept any shipment of marijuana or marijuana product that is not accompanied by the transport manifest



Alaska Marijuana Control Board

Form MJ-01: Marijuana Establishment Operating Plan

Describe how marijuana or marijuana product will be prepared, packaged, and secured for shipment:

Marijuana will be weighed on a certified scale and stored in a sealed container. Each package will include a label with the weight and type of marijuana enclosed. A shipping manifest will be printed and included with every shipment. Marijuana packages will be stored in securely locked box in the vehicle. The shipment will be logged into METRC as well as the name of the authorized shipper, make, model, and license plate of the vehicle. Before leaving, the vehicle will be inspected to make sure it is in sufficient operating condition and enough fuel to prevent any unnecessary stops. The shipper will have a cell phone to report any problems.

Describe the type of locked, safe, and secure storage compartments that will be used in any vehicles transporting marijuana or marijuana product:

The marijuana will be stored in a padlocked steel box during transportation. The box will be securely screwed or bolted to the vehicle.



Alaska Marijuana Control Board

Form MJ-01: Marijuana Establishment Operating Plan

Section 7 – Signage and Advertising

Describe any signs that you intend to post on your establishment with your business name, including quantity and dimensions:

The only signs present on the property will be standard "No Trespassing" signs and a sign at the entrance reading "Restricted access area. Visitors must be escorted". No advertising will be present.

If you are not applying for a retail marijuana store license, you do not need to complete the rest of Section 7, including Page 17.

Restriction on advertising of marijuana and marijuana products (3 AAC 306.360):

All licensed retail marijuana stores must meet minimum standards for signage and advertising.

Applicants should be able to answer "Agree" to all items below.

No advertisement for marijuana or marijuana product will contain any statement or illustration that: Agree Disagree

- | | | |
|---|-------------------------------------|--------------------------|
| Is false or misleading | <input checked="" type="checkbox"/> | <input type="checkbox"/> |
| Promotes excessive consumption | <input checked="" type="checkbox"/> | <input type="checkbox"/> |
| Represents that the use of marijuana has curative or therapeutic effects | <input checked="" type="checkbox"/> | <input type="checkbox"/> |
| Depicts a person under the age of 21 consuming marijuana | <input checked="" type="checkbox"/> | <input type="checkbox"/> |
| Includes an object or character, including a toy, a cartoon character, or any other depiction designed to appeal to a child or other person under the age of 21, that promotes consumption of marijuana | <input checked="" type="checkbox"/> | <input type="checkbox"/> |



Alaska Marijuana Control Board

Form MJ-01: Marijuana Establishment Operating Plan

No advertisement for marijuana or marijuana product will be placed:

Agree Disagree

Within one thousand feet of the perimeter of any child-centered facility, including a school, childcare facility, or other facility providing services to children, a playground or recreation center, a public park, a library, or a game arcade that is open to persons under the age of 21

On or in a public transit vehicle or public transit shelter

On or in a publicly owned or operated property

Within 1000 feet of a substance abuse or treatment facility

On a campus for post-secondary education

Signage and Promotional Materials:

Agree Disagree

I understand and agree to follow the limitations for signs under 3 AAC 306.360(a)

The retail marijuana store will not use giveaway coupons as promotional materials, or conduct promotional activities such as games or competitions to encourage sale of marijuana or marijuana products

All advertising for marijuana or any marijuana product will contain the warnings required under 3 AAC 306.360(e)



Alaska Marijuana Control Board

Form MJ-01: Marijuana Establishment Operating Plan

Section 8 – Control Plan for Persons Under the Age of 21

Describe how the marijuana establishment will prevent persons under the age of 21 from gaining access to any portion of the licensed premises and marijuana items:

No persons under the age of 21 shall be employed. All visitors must verify their age with a state approved ID before entering.

I declare under penalty of perjury that I have examined this form, including all accompanying schedules and statements, and to the best of my knowledge and belief find it to be true, correct, and complete.

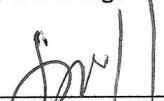

Signature of licensee

Joel Zebill

Printed name

Subscribed and sworn to before me this 30th day of August, 2016.





Notary Public in and for the State of Alaska.

My commission expires: July 15, 2017



Alcohol and Marijuana Control Office
550 W 7th Avenue, Suite 1600
Anchorage, AK 99501

marijuana.licensing@alaska.gov
<https://www.commerce.alaska.gov/web/amco>

Phone: 907.269.0350

Alaska Marijuana Control Board

Form MJ-01: Marijuana Establishment Operating Plan

(Additional Space as Needed):



Alaska Marijuana Control Board

Form MJ-02: Premises Diagram

What is this form?

A detailed diagram of the proposed licensed premises is required for all marijuana establishment license applications, per 3 AAC 306.020(b)(8). Your diagram must show all entrances and boundaries of the premises, restricted access areas, and storage areas, and dimensions. If your proposed premises is located within a building or building complex that contains multiple businesses and/or tenants, please provide an additional page that clearly shows the location of your proposed premises within the building or building complex, along with the addresses and/or suite numbers of the other businesses and/or tenants within the building or building complex. For those applying for a limited marijuana cultivation license, the proposed area(s) for cultivation must be clearly delineated.

The second page of this form is not required. Blueprints, CAD drawings, or other clearly drawn and marked diagrams may be submitted in lieu of the second page of this form. The first page must still be completed, attached to, and submitted with any supplemental diagrams. An AMCO employee may require you to complete the second page of this form if additional documentation for your premises diagram is needed.

This form must be completed and submitted to AMCO's main office before any license application will be considered complete.

Yes No

I have attached blueprints, CAD drawings, or other supporting documents in addition to, or in lieu of, the second page of this form.

Section 1 – Establishment Information

Enter information for the business seeking to be licensed, as identified on the license application.

Licensee:	Joel Zebill	License Number:	10876		
License Type:	Limited Marijuana Cultivation Facility				
Doing Business As:	Hale Harvest				
Premises Address:	18132 Loveall Loop				
City:	Clam Gulch	State:	AK	ZIP:	99568

Top Floor

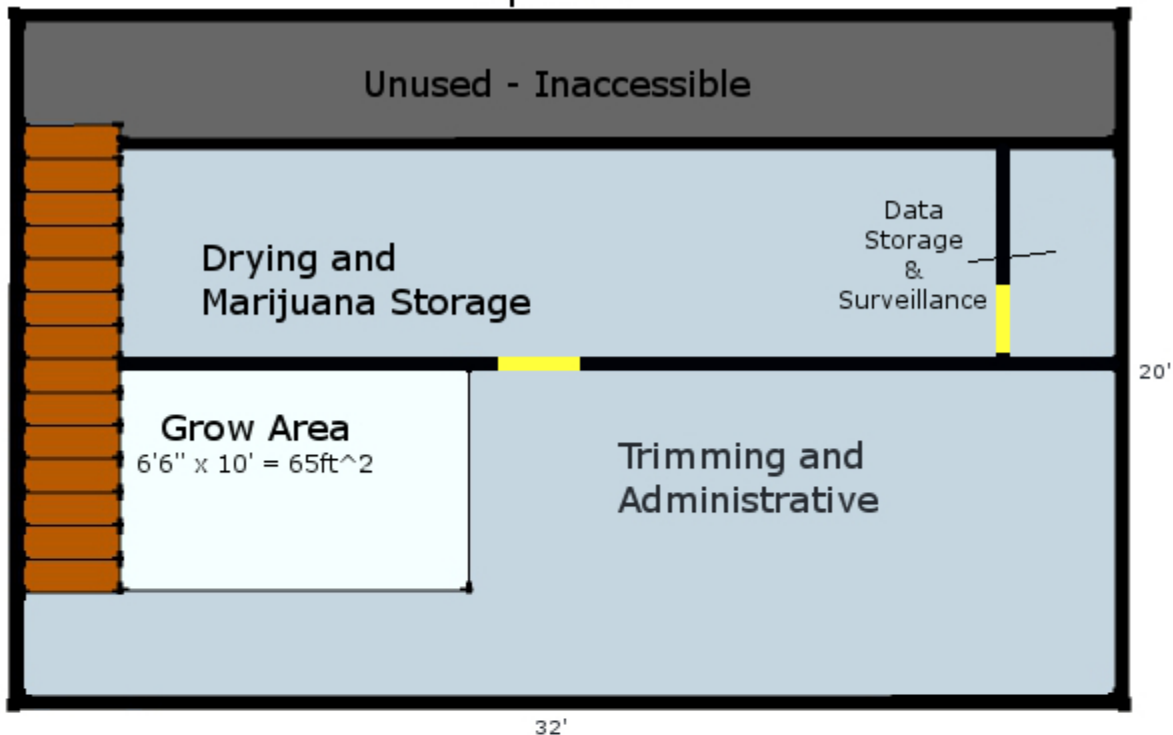

All areas of building are Restricted Access only

Bottom Floor

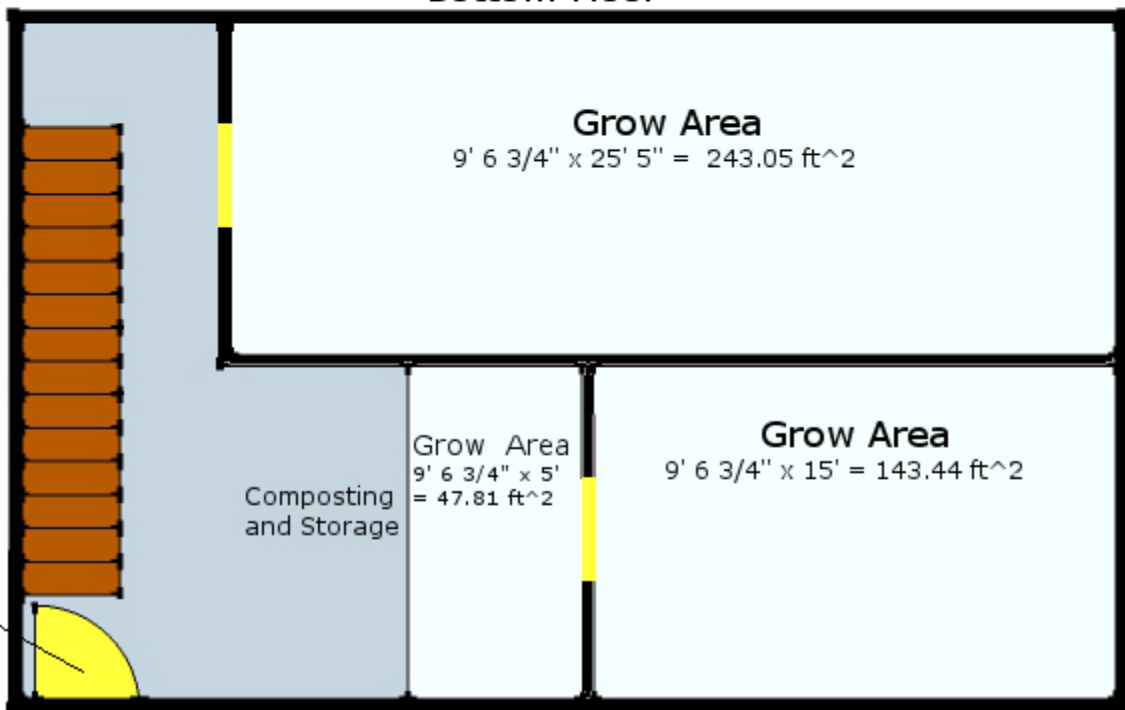

Double locked building entrance

Top Floor

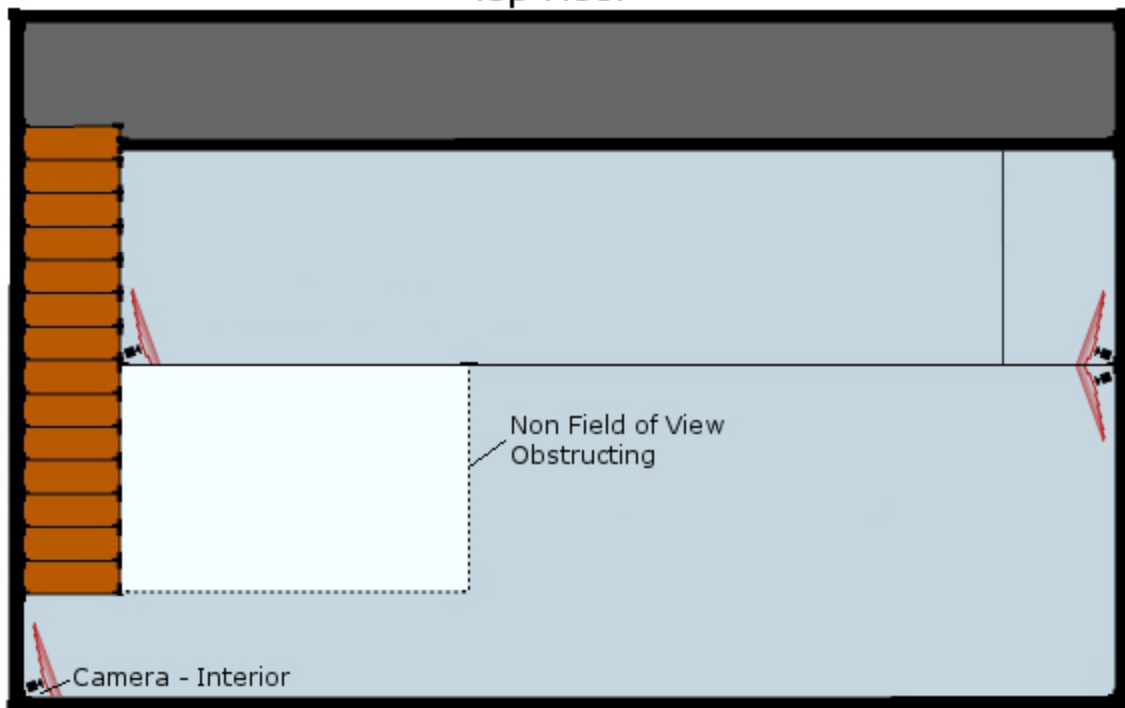

Bottom Floor

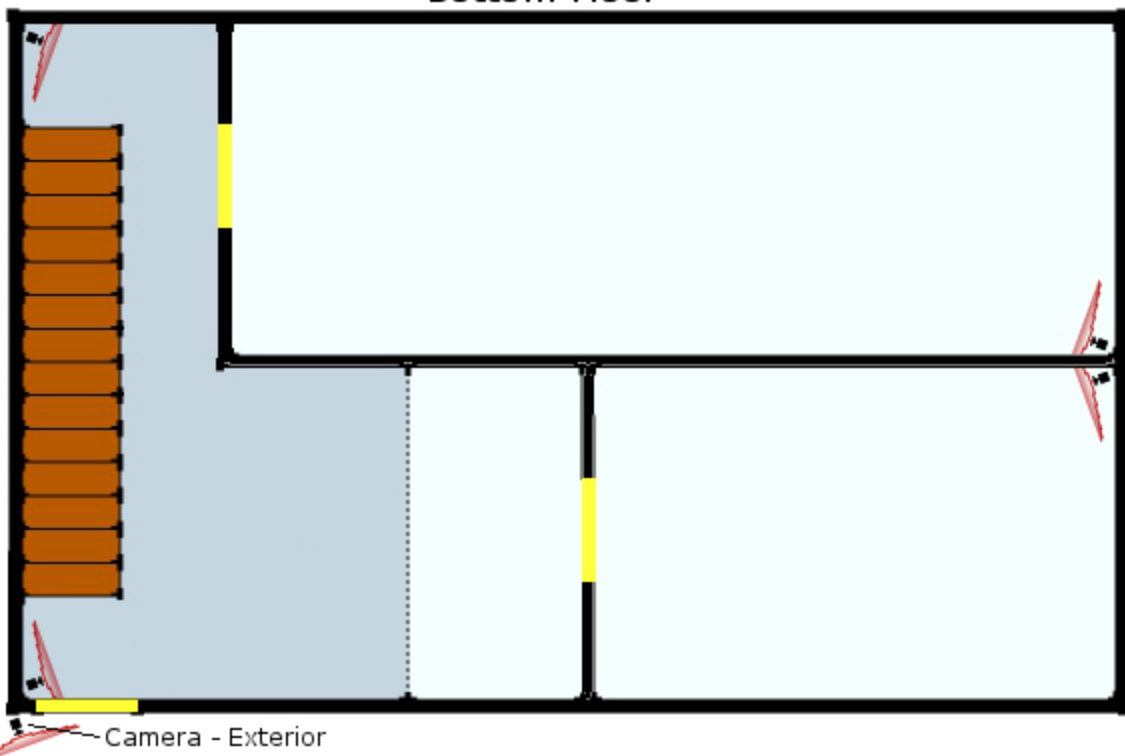

Top Floor

Unused

Drying and
Marijuana Storage

Data
Storage

Grow Area
 $6'6'' \times 10' = 65\text{ft}^2$

Trimming and
Administrative

20'

32'

Bottom Floor

Grow Area
 $9' 6 \frac{3}{4}'' \times 25' 5'' = 243.05 \text{ft}^2$

Composting
and Storage

Grow Area
 $9' 6 \frac{3}{4}'' \times 5' = 47.81 \text{ft}^2$

Grow Area
 $9' 6 \frac{3}{4}'' \times 15' = 143.44 \text{ft}^2$

Top Floor

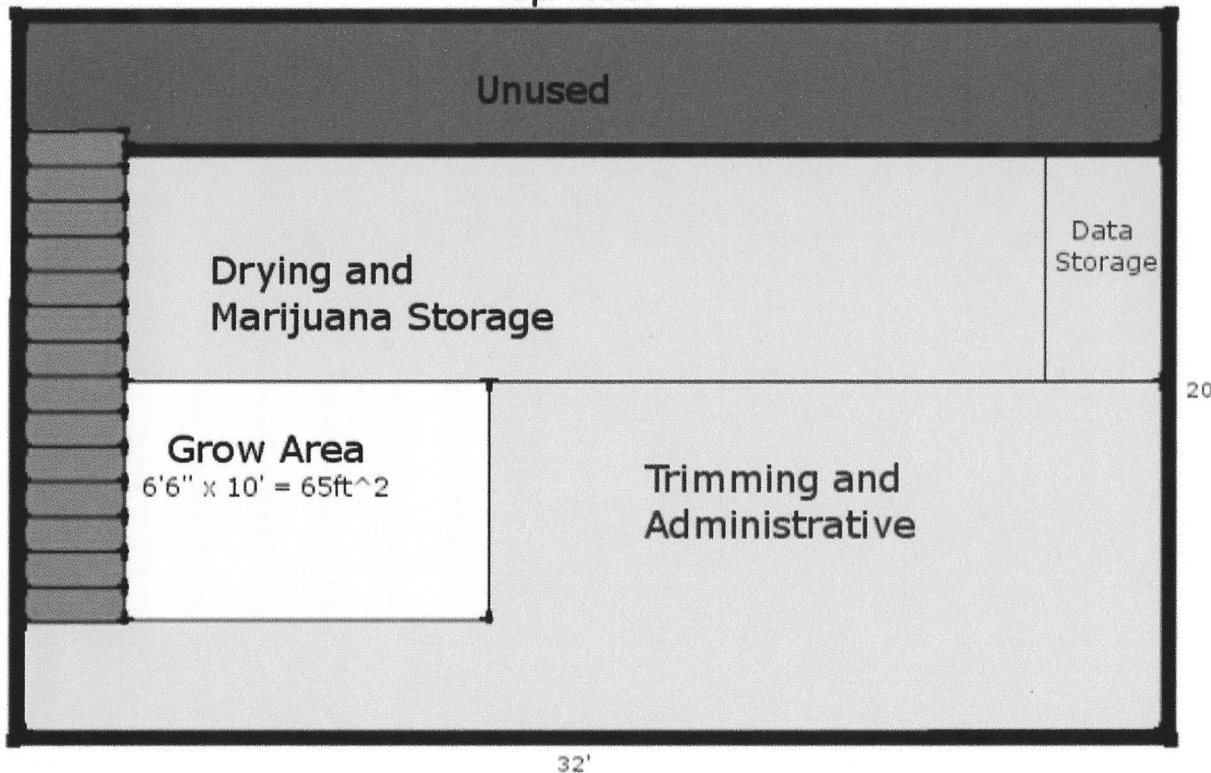

All areas of building are Restricted Access only

12

Bottom Floor

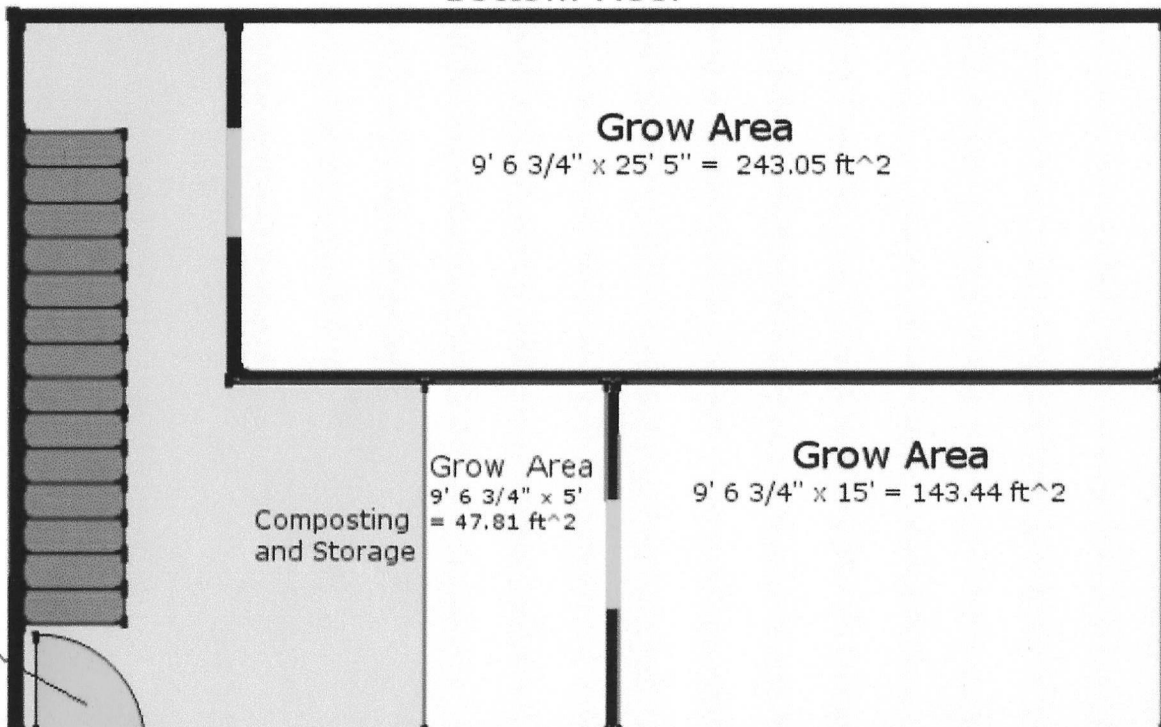

Double locked building entrance

12



Shed

**Owner's
Residence**

**Cultivation
Facility
(Hale Harvest,
Restricted Access)**



Alaska Marijuana Control Board Operating Plan Supplemental Form MJ-04: Marijuana Cultivation Facility

What is this form?

This operating plan supplemental form is required for all applicants seeking a marijuana cultivation facility license and must accompany the **Marijuana Establishment Operating Plan (Form MJ-01)**, per 3 AAC 306.020(b)(11). Applicants should review **Chapter 306: Article 4** of the **Alaska Administrative Code**. This form will be used to document how an applicant intends to meet the requirements of those regulations. If your business has a formal operating plan, you may include a copy of that operating plan with your application, but all fields of this form must still be completed per 3 AAC 306.020 and 3 AAC 306.420(2).

What additional information is required for cultivation facilities?

Applicants must identify how the proposed establishment will comply with applicable regulations regarding the following:

- Prohibitions
- Cultivation plan
- Odor control
- Testing procedure and protocols
- Security

This form must be submitted to AMCO's main office before any marijuana cultivation facility license application will be considered complete.

Section 1 – Establishment Information

Enter information for the business seeking to be licensed, as identified on the license application.

Licensee:	Joel Zebill	License Number:	10876		
License Type:	Limited Marijuana Cultivation Facility				
Doing Business As:	Hale Harvest				
Premises Address:	18132 Loveall Loop				
City:	Clam Gulch	State:	ALASKA	ZIP:	99568



Alaska Marijuana Control Board
Operating Plan Supplemental
Form MJ-04: Marijuana Cultivation Facility

Alcohol and Marijuana Control Office
 550 W 7th Avenue, Suite 1600
 Anchorage, AK 99501
marijuana.licensing@alaska.gov
<https://www.commerce.alaska.gov/web/amco>
 Phone: 907.269.0350

Section 2 – Prohibitions

Applicants should review 3 AAC 306.405 – 3 AAC 306.410 and be able to answer “Agree” to all items below.

The marijuana cultivation facility will not:

Agree Disagree

Sell, distribute, or transfer any marijuana or marijuana product to a consumer, with or without compensation

Allow any person, including a licensee, employee, or agent, to consume marijuana or marijuana product on its license premises or within 20 feet of the exterior of any building or outdoor cultivation facility

Treat or otherwise adulterate marijuana with any organic or nonorganic chemical or compound to alter the color, appearance, weight, or odor of the marijuana

Section 3 – Cultivation Plan

Review the requirements under 3 AAC 306.420, and identify how the proposed premises will meet the listed requirements.

Describe the size of the space(s) the marijuana cultivation facility intends to be under cultivation, including dimensions and overall square footage. Provide your calculations below:

There will be four separate grow areas, in one building. their dimensions and square footage are:
 $9' 6 \frac{3}{4}'' \times 25' 5'' = 243.05 \text{ ft}^2$
 $9' 6 \frac{3}{4}'' \times 15' = 143.44 \text{ ft}^2$
 $9' 6 \frac{3}{4}'' \times 5' = 47.81 \text{ ft}^2$
 $6' 6'' \times 10' = 65 \text{ ft}^2$

Total growing area will be 499.3 ft².



Alaska Marijuana Control Board
Operating Plan Supplemental
Form MJ-04: Marijuana Cultivation Facility

Alcohol and Marijuana Control Office
550 W 7th Avenue, Suite 1600
Anchorage, AK 99501

marijuana.licensing@alaska.gov
<https://www.commerce.alaska.gov/web/amco>
Phone: 907.269.0350

Describe the marijuana cultivation facility's growing medium(s) to be used:

The plants will be grown in Bato buckets using dirt. This dirt will be supplemented over time with compost from the plant waste.

Describe the marijuana cultivation facility's fertilizers, chemicals, gases, and delivery systems, including carbon dioxide management, to be used:

Hydro Organics Earth Juice Rootstock - rooting gel
Bat guano - fertilizer
Bone meal - fertilizer
Blood meal - fertilizer
Hydro Organics Earth Juice Sweet and Heavy - fertilizer
Hydro Organics Earth Juice Grow - fertilizer
Hydro Organics Earth Juice Microblast - fertilizer
Hydro Organics Earth Juice Double Up - Ph adjuster
Hydro Organics Earth Juice Natural Down - Ph adjuster
continued on last page

Describe the marijuana cultivation facility's irrigation and waste water systems to be used:

A combination of well water and captured rain will be used to irrigate the marijuana crops. The plants will be individually watered using a drip irrigation system. Excess runoff from irrigation will be drained into a drain field.



Alaska Marijuana Control Board
Operating Plan Supplemental
Form MJ-04: Marijuana Cultivation Facility

Alcohol and Marijuana Control Office
550 W 7th Avenue, Suite 1600
Anchorage, AK 99501
marijuana.licensing@alaska.gov
<https://www.commerce.alaska.gov/web/amco>
Phone: 907.269.0350

Describe the marijuana cultivation facility's waste disposal arrangements:

Marijuana solid waste will be ground and composted for future use as soil. Non-marijuana solid waste will be delivered to the local waste transfer site on a timely basis by either the owner or designated employee. Surplus runoff from irrigation and wastewater from handwashing will be drained into a drain field on the property.

Section 4 – Odor Control

Review the requirements under 3 AAC 306.430, and identify how the proposed premises will meet the listed requirement.

Describe the odor control method(s) to be used and how the marijuana cultivation facility will ensure that any marijuana at the facility does not emit an odor that is detectable by the public from outside the facility:

All air will exit the cultivation facility at a single point. The air leaving will be treated with sufficient ozone to ensure that no marijuana smell remains. In addition a carbon filter may be employed if to remove any trace odors of marijuana or ozone. An active ventilation system ventilation system will be maintained sufficient to ensure that all air exits the one location and that all other areas including the entrance are under slight negative pressure to eliminate any possible nuisance smell from emanating.



Alaska Marijuana Control Board Operating Plan Supplemental Form MJ-04: Marijuana Cultivation Facility

Section 5 – Testing Procedure and Protocols

Review the requirements under 3 AAC 306.455 and 3 AAC 306.465, and identify how the proposed premises will meet the listed requirements.

Applicants should be able to answer "Agree" to the item below.

I understand and agree that:

Agree Disagree

The board will or the director shall from time to time require the marijuana cultivation facility to provide samples of the growing medium, soil amendmants, fertilizers, crop production aids, pesticides, or water for random compliance checks

Describe the testing procedure and protocols the marijuana cultivation facility will follow:

All harvested marijuana from a single batch of not more that fifty plants will be segregated into a single container. Designated personnel shall take from this batch a random sample of sufficient amount for the testing facilities requirements. The same personnel shall prepare a signed statement assuring that the sample taken was a random sample from the designated batch for the purpose of testing. The personnel shall provide this statement to the testing facility as well as maintaing a copy for business records. The sample shall then be transported to a testing facility following all applicable regulations under 3 AAC 306.750. Until the results are obtained on the sample which was tested, the batch from which it was obtained shall be securely stored in a cool, dry location to prevent contamination or loss of efficacy. Once the results are obtained from the testing facility, in writing, the results will be maintained as part of the business records and the batch may then be sold to an authorized retailer or manufacturer pursuant to to all relevant regulations.
If at any time the marijuana control board or it's director requests a sample of Hale Harvest's growing medium, soil amendmants, fertilizers, crop production aids, pesticides, or water, Hale Harvest's personnel will cooperate fully with the licensed testing facility, that has been designated by the board, to obtain the neccesary samples to perform the testing requested. All costs for this testing will borne by Hale Harvest.



Alaska Marijuana Control Board
Operating Plan Supplemental
Form MJ-04: Marijuana Cultivation Facility

Alcohol and Marijuana Control Office
 550 W 7th Avenue, Suite 1600
 Anchorage, AK 99501
marijuana.licensing@alaska.gov
<https://www.commerce.alaska.gov/web/amco>
 Phone: 907.269.0350

Section 6 – Security

Review the requirements under 3 AAC 306.430 and 3 AAC 306.470 – 3 AAC 306.475, and identify how the proposed premises will meet the listed requirements.

Applicants should be able to answer “Agree” to the two items below.

The marijuana cultivation facility applicant has:

Agree Disagree

Read and understands and agrees to the packaging of marijuana requirements under 3 AAC 306.470

Read and understands and agrees to the labeling of marijuana requirements under 3 AAC 306.475

Restricted Access Area (3 AAC 306.430):

Yes No

Will the marijuana cultivation facility include outdoor production?

If “Yes”, describe the outdoor structure(s) or the expanse of open or clear ground fully enclosed by a physical barrier:



Alaska Marijuana Control Board Operating Plan Supplemental Form MJ-04: Marijuana Cultivation Facility

Describe the method(s) used to ensure that any marijuana at the marijuana cultivation facility cannot be observed by the public from outside the facility:

The cultivation facility used by Hale Harvest has no windows and a single solid door with no window. All cultivation will be performed inside of this structure. At no point will the marijuana plants be visible to the public.

I certify that as a marijuana cultivation facility, I will submit monthly reports to the Department of Revenue and pay the excise tax required under AS 43.61.010 and 43.61.020 on all marijuana sold or provided as a sample to a marijuana establishment, as required under 3 AAC 306.480.

I declare under penalty of perjury that I have examined this form, including all accompanying schedules and statements, and to the best of my knowledge and belief find it to be true, correct, and complete.

Signature of licensee

Joel Zebell

Printed name

Subscribed and sworn to before me this 30th day of August, 2016.

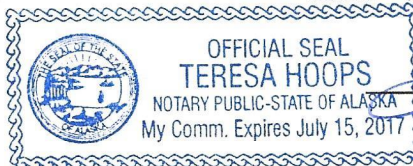

Teresa Hoops
Notary Public in and for the State of Alaska.

My commission expires: July 15, 2017



Alaska Marijuana Control Board
**Operating Plan Supplemental
Form MJ-04: Marijuana Cultivation Facility**

Alcohol and Marijuana Control Office
550 W 7th Avenue, Suite 1600
Anchorage, AK 99501
marijuana.licensing@alaska.gov
<https://www.commerce.alaska.gov/web/amco>
Phone: 907.269.0350

(Additional Space as Needed):

continued from page 3:
Aurora Innovations Root Organics Extreme Serene - fertilizer
Aurora Innovations Root Organics HPK - fertilizer
Cutting Edge Solutions Sugaree - fertilizer
Rock Phosphate - fertilizer
Genhydro AzaMax - organic pesticide
Fishy Peat Organic Potting Soil - dirt



Alaska Marijuana Control Board

Form MJ-07: Public Notice Posting Affidavit

What is this form?

A public notice posting affidavit is required for all marijuana establishment license applications, per 3 AAC 306.020(b)(10). As soon as practical after initiating a new marijuana establishment license application, an applicant must give notice of the application to the public by posting a copy of the application (produced by the board's application website) for ten (10) days at the location of the proposed licensed premises and one other conspicuous location in the area of the proposed premises, per 3 AAC 306.025(b)(1).

This form must be completed and submitted to AMCO's main office before any license application will be considered complete.

Section 1 – Establishment Information

Enter information for the business seeking to be licensed, as identified on the license application.

Licensee:	Joel Zebill	License Number:	10876		
License Type:	Limited Marijuana Cultivation Facility				
Doing Business As:	Hale Harvest				
Premises Address:	18132 Loveall Loop				
City:	Clam Gulch	State:	AK	ZIP:	99568

Section 2 – Certification

I certify that I have met the public notice requirement set forth under 3 AAC 306.025(b)(1) by posting a copy of my application for the following 10-day period at the location of the proposed licensed premises and at the following conspicuous location in the area of the proposed premises:

Start Date: 8/10/2016 End Date: 8/21/2016

Other conspicuous location: Clam Gulch Post Office

I declare under penalty of perjury that I have examined this form, including all accompanying schedules and statements, and to the best of my knowledge and belief find it to be true, correct, and complete.

[Signature]
 Signature of licensee

Joel Zebill
 Printed name of licensee

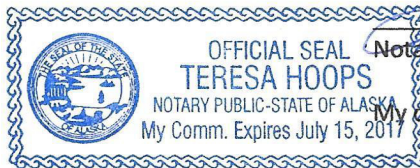

[Signature]
 Notary Public in and for the State of Alaska

My Commission expires: July 15, 2017

Subscribed and sworn to before me this 30th day of August, 2016.



Alaska Marijuana Control Board
Form MJ-08: Local Government Notice Affidavit

What is this form?

A local government notice affidavit is required for all marijuana establishment license applications with a proposed premises that is located within a local government, per 3 AAC 306.025(b)(3). As soon as practical after initiating a new marijuana establishment license application, an applicant must give notice of the application to the public by submitting a copy of the application to the local government and any community council in the area of the proposed licensed premises. For purposes of this notification, the document that must be submitted is the application document produced by the online application system titled "Public Notice".

This form must be completed and submitted to AMCO's main office before any license application will be considered complete.

Section 1 – Establishment Information

Enter information for the business seeking to be licensed, as identified on the license application.

Licensee:	Joel Zebill	License Number:	10876		
License Type:	Limited Marijuana Cultivation Facility				
Doing Business As:	Hale Harvest				
Premises Address:	18132 Loveall Loop				
City:	Clam Gulch	State:	AK	ZIP:	99568

Section 2 – Certification

I certify that I have met the local government notice requirement set forth under 3 AAC 306.025(b)(3) by submitting a copy of my application to the following local government official and community council (if applicable):

Local Government: Kenai Peninsula Burrough Name of Official: Katie Ring
 Title of Official: Burrough Clerk Secretary Date Submitted: 10/14/16
 Community Council: N/A Date Submitted: N/A
 (Municipality of Anchorage and Matanuska-Susitna Borough only)

I declare under penalty of perjury that I have examined this form, including all accompanying schedules and statements, and to the best of my knowledge and belief find it to be true, correct, and complete.

[Signature]
 Signature of licensee
Joel Zebill
 Printed name of licensee

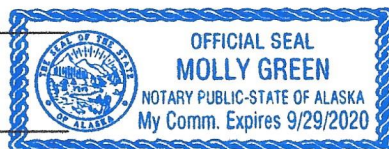

[Signature]
 Notary Public in and for the State of Alaska
 My commission expires: 9-29-2020

Subscribed and sworn to before me this 20 day of October, 2016



Alaska Marijuana Control Board

Form MJ-09: Statement of Financial Interest

What is this form?

A statement of financial interest completed by each proposed licensee (as defined in 3 AAC 306.020(b)(2)) and affiliate (as defined in 3 AAC 306.990(a)(1)) is required for all marijuana establishment license applications, per 3 AAC 306.020(b)(4). A person other than a licensee may not have direct or indirect financial interest (as defined in 3 AAC 306.015(e)(1)) in the business for which a marijuana establishment license is issued, per 3 AAC 306.015(a).

This form must be completed and submitted to AMCO's main office by each proposed licensee or affiliate before any license application will be considered complete.

Section 1 – Establishment Information

Enter information for the business seeking to be licensed, as identified on the license application.

Licensee:	Joel Zebill	License Number:	10876		
License Type:	Limited Marijuana Cultivation Facility				
Doing Business As:	Hale Harvest				
Premises Address:	18132 Loveall Loop				
City:	Clam Gulch	State:	AK	ZIP:	99568

Section 2 – Individual Information

Enter information for the individual licensee or affiliate.

Name:	Joel Zebill				
Title:	Owner				
SSN:	[REDACTED]				



Alaska Marijuana Control Board

Form MJ-09: Statement of Financial Interest

Section 3 – Certifications

I certify that no person other than a proposed licensee listed on my marijuana establishment license application has a direct or indirect financial interest, as defined in 3 AAC 306.015(e)(1), in the business for which a marijuana establishment license is being applied for.

I further certify that any ownership change shall be reported to the board as required under 3 AAC 306.040.

I declare under penalty of perjury that I have examined this form, including all accompanying schedules and statements, and to the best of my knowledge and belief find it to be true, correct, and complete.

Joel Zebell
Signature of licensee/affiliate

Joel Zebell
Printed name

Subscribed and sworn to before me this 30th day of August, 2016.



Teresa Hoops
Notary Public in and for the State of Alaska.
My commission expires: July 15, 2017

Alcohol & Marijuana Control Office

License Number: 10876

License Status: New

License Type: Limited Marijuana Cultivation Facility

Doing Business As: HALE HARVEST

Business License Number: 1038707

Designated Licensee: JOEL H ZEBILL

Email Address: joel_zebill@yahoo.com

Local Government: Kenai Peninsula Borough

Community Council:

Latitude, Longitude: 60.243865, -151.370098

Physical Address: 18132 Loveall Loop
Clam Gulch, AK 99568
UNITED STATES

Owner #1

Note: No affiliates entered for this license.

Licensee Type: Individual

Name: JOEL H ZEBILL

SSN: [REDACTED]

Date of Birth: 02/28/1983

Phone Number: 605-651-3029

Email Address: joel_zebill@yahoo.com

Mailing Address: PO Box 3625
Soldotna, AK 99669
UNITED STATES

KSRM INC.
40960 K-BEACH RD.
KENAI, ALASKA 99611
(907)335-5302 ext 323

Client: 47280 HALE HARVEST
For: HALE HARVEST 30 seconds
Begin: 2/17/17 End: 3/2/17
APPLYING FOR LICENSE

Joel H Zebill is applying under 3 AAC 306.400(a)(2) for a new Limited Marijuana Cultivation Facility license.

License #10876, doing business as Hale Harvest, located at 18132 Loveall Loop, Clam Gulch, AK. 99568 United States.

Interested persons should submit written comment or objection to their local government, the applicant, and to the Alcohol & Marijuana Control Office at 550 W 7th Ave., Suite 1600, Anchorage, AK 99501 or to marijuana.licensing@alaska.gov not later than 30 days after this notice of application.

This announcement was broadcast 6 times, as entered in the station's program log. The times this announcement was broadcast were billed to the advertiser on the station's invoice number 165619 dated 3/6/17 at the following rates:

\$18.00	each for	6	announcements, for a total of	\$108.00
			Plus Sales Tax	\$3.24
			Net Invoice Amount	\$111.24

Station Officials:

1-7-2021
My Commission Expires

KSRM INC.
3/6/17

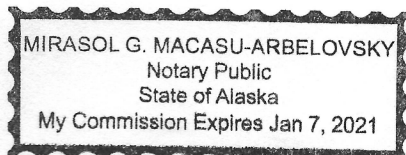

AFFIDAVIT OF PERFORMANCE - HALE HARVEST - KWHQ 100.1FM

Affidavit of Performance
From: 02/17/2017 To: 02/28/2017
KWHQ

Air Date	Air Time	Spot,Cut	Spot Title
02/17/2017 00:30.003	15:57:06	0000093-001	HALE HARVEST - LICENSE 10876
02/18/2017 00:30.003	12:53:00	0000093-001	HALE HARVEST - LICENSE 10876
02/22/2017 00:30.003	16:57:10	0000093-001	HALE HARVEST - LICENSE 10876
02/23/2017 00:30.003	17:56:17	0000093-001	HALE HARVEST - LICENSE 10876
02/27/2017 00:30.003	06:51:51	0000093-001	HALE HARVEST - LICENSE 10876
02/28/2017 00:30.003	06:52:18	0000093-001	HALE HARVEST - LICENSE 10876

THE ABOVE ITEMS WERE BROADCAST AT THE TIME SPECIFIED
ACCORDING TO THE OFFICIAL STATION LOG



Station Representative

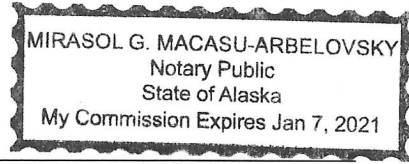

Notary Public

1 - 7 - 2021

From: [Hale Harvest](#)
To: [Marijuana Licensing \(CED sponsored\)](#)
Subject: Re: Corrections reviewed-more docs/info needed-Hale Harvest license #10876
Date: Thursday, March 16, 2017 9:28:22 PM
Attachments: [Cover Page .pdf](#)
[Revised MJ-02 Premesis Diagram 2.pdf](#)
[Publisher's Affidavit - Additional Document.pdf](#)

Jane Sawyer

I enclosed a revision to the layout drawings. One page shows where the surveillance room is and the other shows camera positions.

I also included an affidavit listing the specific times the announcements aired. There is nothing that specifically says "triple A advertising" because Radio Kenai, which runs most of the stations down here, does not recognize that term. The announcements were run during prime advertising time. Below is an email reply we received when we inquired about triple A advertising for the first radio run. They assumed, like we have, that it means advertising during their highest rated time slot.

----- Forwarded message -----
From: **Nathan Johnson** <nathan@radiokenai.com>
Date: Tue, Aug 30, 2016 at 10:38 AM
Subject: KSRM Radio Group
To: haleharvest@gmail.com

Good morning Joel,

Not sure what Triple A time is, we run two different time brackets, DAP- Daily Audience Plan which is 6am-7pm and TAP- Total Audience Plan 6am-12am. Which means the ads will run during those times. I'm guessing triple A would be TAP 6am-12am. I can get you started on this Thursday if you like and your affidavit would be ready at the end of the month 27th 28th, I might be able to get it done sooner but not till all the ads have ran. Here is a copy of our current rates. Let me know what you would like to do. Payment to be made prior to ads running. If you have any questions please ask. Thanks Joel, have a great day.

Nathan

Nathan Johnson- marketing consultant

Cell number- 398-2628-Best number

Office Number 283-8700 Fax 283-9177

email: nathan@radiokenai.com

KSRM Radio Group

KSRM-920am ,KKIS-96.5fm,KLSD-1140am, KWHQ-100.1fm ,KFSE-106.9fm

listen online @ radiokenai.com or download our app from Itunes & Google play

Thank you

Joel Zebill
Owner
Hale Harvest