



Planning Department

144 N. Binkley Street, Soldotna, Alaska 99669 • (907) 714-2200 • (907) 714-2378 Fax

February 18, 2020

Charlie Pierce
Borough Mayor

KENAI PENINSULA BOROUGH PLANNING COMMISSION NOTICE OF PUBLIC HEARING

Public notice is hereby given that the Kenai Peninsula Borough has been notified of an application for a Retail Marijuana Store license in the Cooper Landing Area. The Borough will hold a public hearing prior to providing comments to the State on this application. This notice is being sent to landowners located within a 300-foot radius of the subject property. All members of the public are invited to comment. The application under consideration is described as follows:

Applicant: Arctic Herbery

Please turn over for map.

Landowner: Glenn Sackett

Parcel Number: 119-030-02

Property Description: U.S. Survey 3388, Section 36, Township 5 North, Range 4 West, Seward Meridian.

Location: 16021 Sterling Highway, Cooper Landing, AK 99572

Proposed Land Use: The applicant wishes to obtain a license from the Alaska Marijuana Control Board for a Retail Marijuana Store on the parcel listed above.

Applicable Code: State marijuana applications are reviewed by the borough in accordance with KPB 7.20 and 7.30. Copies of these ordinances are available from the Clerk's Office or on the KPB website at: kpb.us. State regulations (3 AAC 306) allow local jurisdictions to protest the issuance of marijuana licenses and recommend conditions to be placed upon licenses.

Cooper Landing Advisory Planning Commission Meeting: A meeting will be held by the Cooper Landing Advisory Planning Commission to consider the application on **Wednesday, March 18, 2020**, commencing at 6:00 p.m. The meeting will be held at the Cooper Landing Community Hall, 18511 Bean Creek Rd.

Public Hearing: A hearing will be held by the Kenai Peninsula Borough Planning Commission to consider the application on **Monday, March 23, 2020**, commencing at 7:30 p.m., or as soon thereafter as business permits. The meeting will be held in the assembly chambers of the borough administration building located at 144 N. Binkley Street, Soldotna, Alaska.

Public Comment: Those wishing to comment may come to the above meetings to give testimony or may submit a written statement addressed to: Planning Commission Chairman, 144 N. Binkley, Soldotna, Alaska 99669. A statement addressed to the chairman may also be emailed to: bwall@kpb.us, or faxed to (907) 714-2378. Please provide written statements by 1:00 P.M., Friday, March 20, 2020.

For additional information about this application, please call the planning department at (907) 714-2206, or 1-800-478-4441 (toll free within the Kenai Peninsula Borough).

Bruce Wall, AICP
Planner

Cooper Landing Advisory Planning Commission Meeting - March 18, 2020
 Kenai Peninsula Borough Planning Commission Meeting - March 23, 2020
 Assembly Meeting - April 7, 2020

Recommendation on an Application for a State Marijuana Establishment License

KPB Parcel ID: 119-030-02 Address: 160210 Sterling Highway

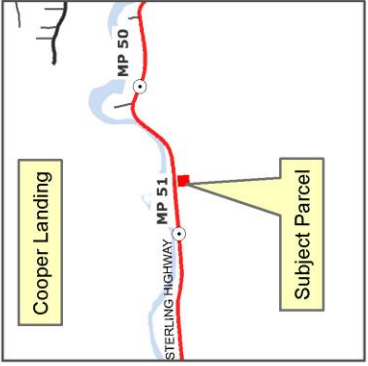
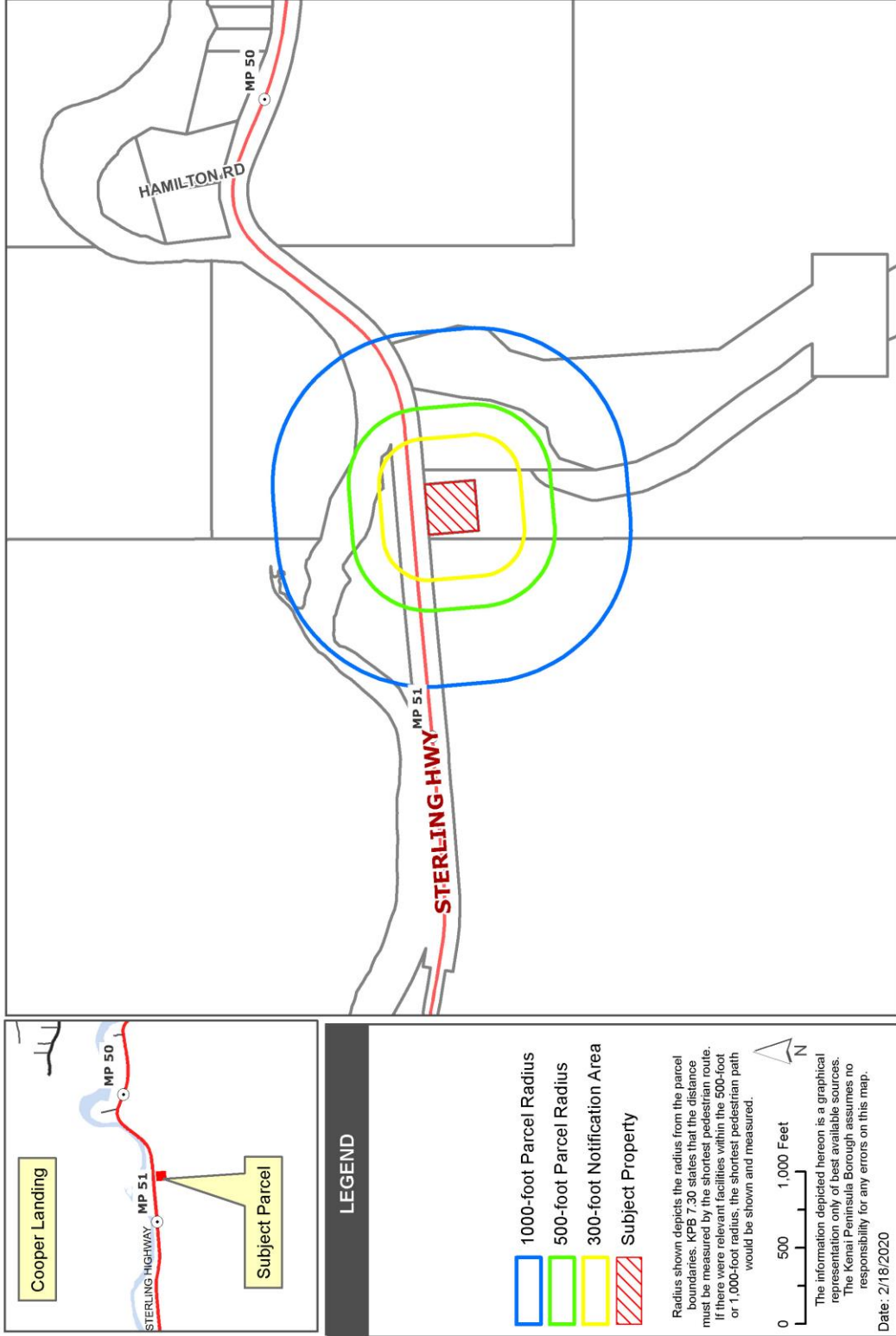

LEGEND

- 1000-foot Parcel Radius
- 500-foot Parcel Radius
- 300-foot Notification Area
- ▨ Subject Property

Radius shown depicts the radius from the parcel boundaries. KPB 7:30 states that the distance must be measured by the shortest pedestrian route. If there were relevant facilities within the 500-foot or 1,000-foot radius, the shortest pedestrian path would be shown and measured.

0 500 1,000 Feet

The information depicted hereon is a graphical representation only of best available sources. The Kenai Peninsula Borough assumes no responsibility for any errors on this map.

Date: 2/18/2020