

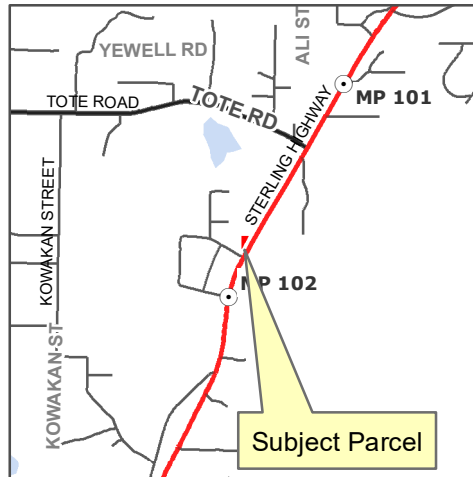

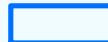



Kenai Peninsula Borough Planning Commission Meeting - January 7, 2019  
Assembly Meeting - January 22, 2019  
Recommendation on an Application for a State Marijuana Establishment License

KPB Parcel ID: 131-170-11  
Applicant: Mary's Garden

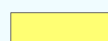
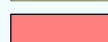
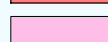

**LEGEND**

-  1000-foot Parcel Radius
-  500-foot Parcel Radius
-  Subject Property
-  Vacant
-  Residential
-  Commercial
-  Institutional
-  Accessory Building

Radius shown depicts the radius from the parcel boundaries. KPB 7.30 states that the distance must be measured by the shortest pedestrian route. If there were relevant facilities within the 500-foot or 1,000-foot radius, the shortest pedestrian path would be shown and measured.

0 250 500 Feet



The information depicted hereon is a graphical representation only of best available sources. The Kenai Peninsula Borough assumes no responsibility for any errors on this map.

Date: 12/10/2018

