



South
Peninsula
Hospital

South Peninsula Hospital Report

Prepared for

Kenai Peninsula Borough Assembly

August 5, 2025

*South Peninsula Hospital is the healthcare provider of choice,
with a dynamic and dedicated team committed to service excellence.*

SOUTH PENINSULA HOSPITAL OWNERSHIP AND GOVERNANCE

KENAI PENINSULA BOROUGH

South Kenai Peninsula Hospital Service Area Board

Helen Armstrong (President), Kathryn Ault, Ralph Broshe, Amber Cabana, Tim Daugharty, Lynda Reed, Francie Roberts, Tamara Fletcher, Erin Workman

[Ordinance 69-4](#)
[Ordinance 73-33](#)
[Ordinance 2007-28](#)

Advisory to Mayor & Assembly

Service Area Budget approval

SPH Service Area budget proposal

President



Peter Ribbens

VP



Kelly Cooper



Tyson Cox



Ryan Tunseth



Cindy Ecklund



Leslie Morton



James Baisden



Brent Johnson



Willy Dunne

Kenai Peninsula Borough Assembly

Lands Committee • Finance Committee

Resolutions
Ordinances
Proposals

Borough Mayor's Office

Borough Mayor

Peter Micciche

Departments

Finance • Purchasing • Capital Projects



City of Homer

Homer City Mayor

Rachel Lord

City Council

Donna Aderhold, Shelly Erickson, Storm Hansen-Cavasos, Caroline Venuti, Jason Davis, Bradley Parsons

SPH Foundation, Inc.

Board of Trustees

Dr. Rob Downey (Chair), Holly Dramis, Dotti Harness-Foster, Amy Landess, Tiffany Park

[SPHFI Articles of Incorporation](#)

Operating Agreement

Contract Administrator

Land Lease

South Peninsula Hospital, Inc.

President



Aaron Weissner

Vice President



Preston Simmons

Secretary



Beth Wythe

Treasurer



Walter Partridge

Board of Directors



Christopher Landess, MD



Matthew Bullard



Michael Dye



Edson Knapp, MD



Kim Frost



Bernadette Wilson

Committees: Executive • Finance • Governance

SPH Medical Staff

Chief of Staff



Sarah Roberts, MD

Medical Executive Committee

Nathan Kincaid, MD; Hans Amen, DO; Brian McCorison, CRNA; Brent Adcox, MD; Lucy Fisher, MD; Giulia Tortora, MD

Medical Providers

Operational needs & strategies



SPH CEO

Ryan Smith

Funding & directives

Leadership Team of SPH

COO



Rachael Kincaid, DNP

CFO



Anna Hermanson

CMO



Christina Tuomi, DO

CNO



Amber Gall, RN

DIRECT REPORTS ▲ STAFF, RESOURCES & DEPARTMENTS ▲ COMMITTEES

SPH Auxiliary



Welcome New Service Area Board Member



Erin Workman, BSN, RN

Appointed July 2025

Clinical Instructor for UAA Nursing Program –
Homer Chapter (recently retired)

Gross Patient Revenue-Q4 YTD FY25

(in thousands)

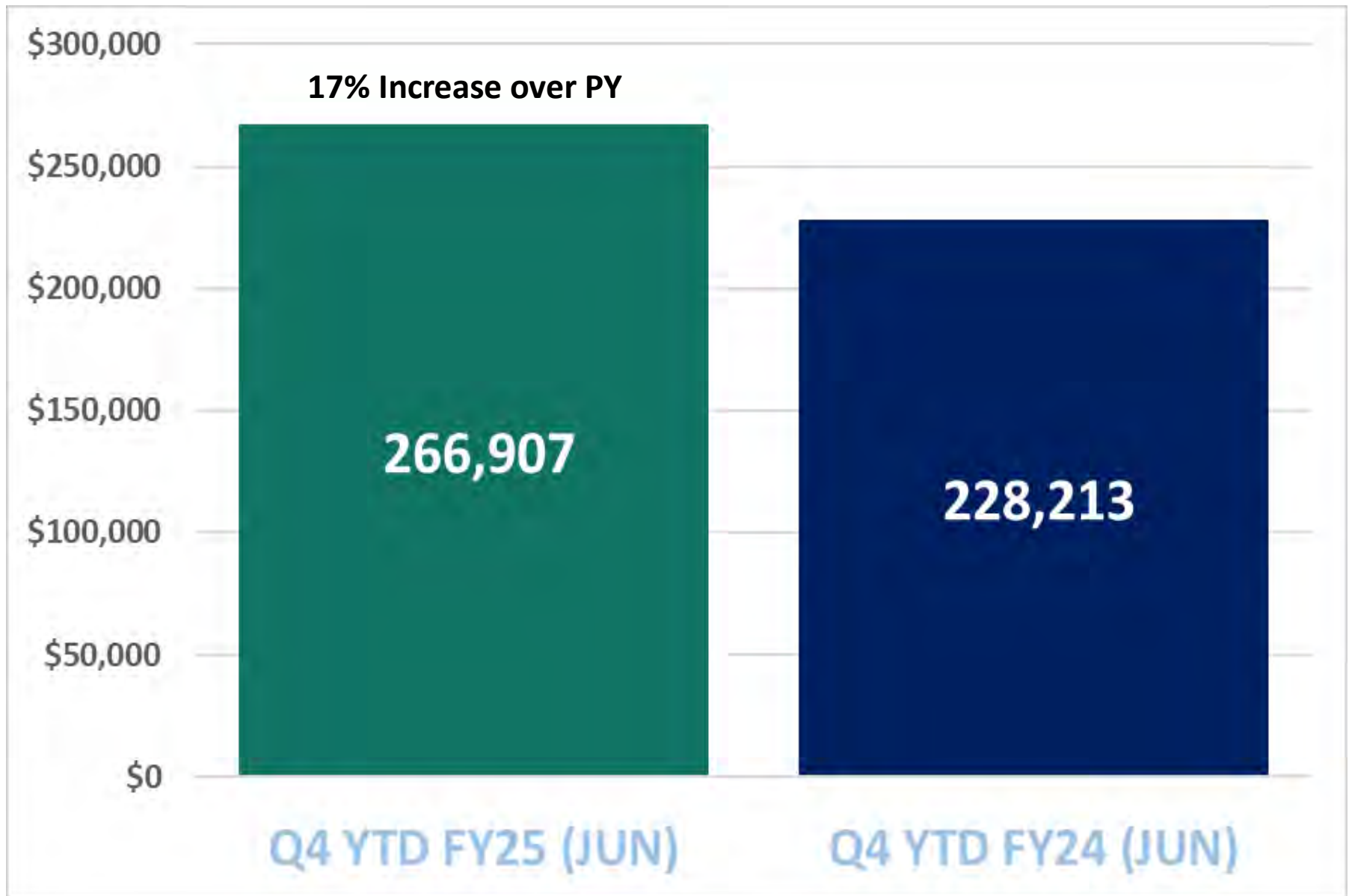

Operating Income-Q4 YTD FY25

(in thousands)

241% increase over PY

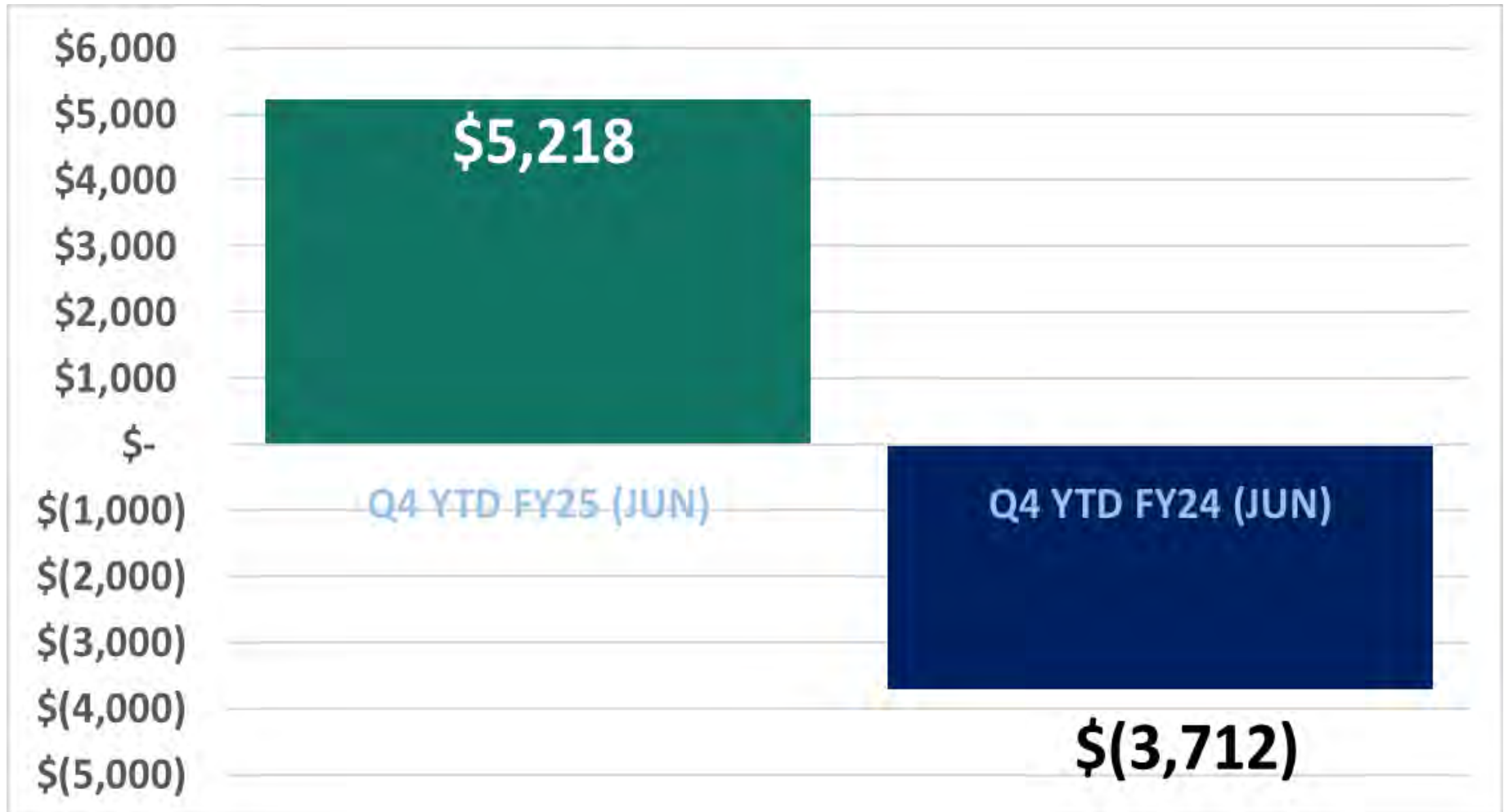

Net Income-Q4 YTD FY25

(in thousands)

200% Increase over PY



Charity Care & Bad Debt-Q4 YTD FY25

(in thousands)

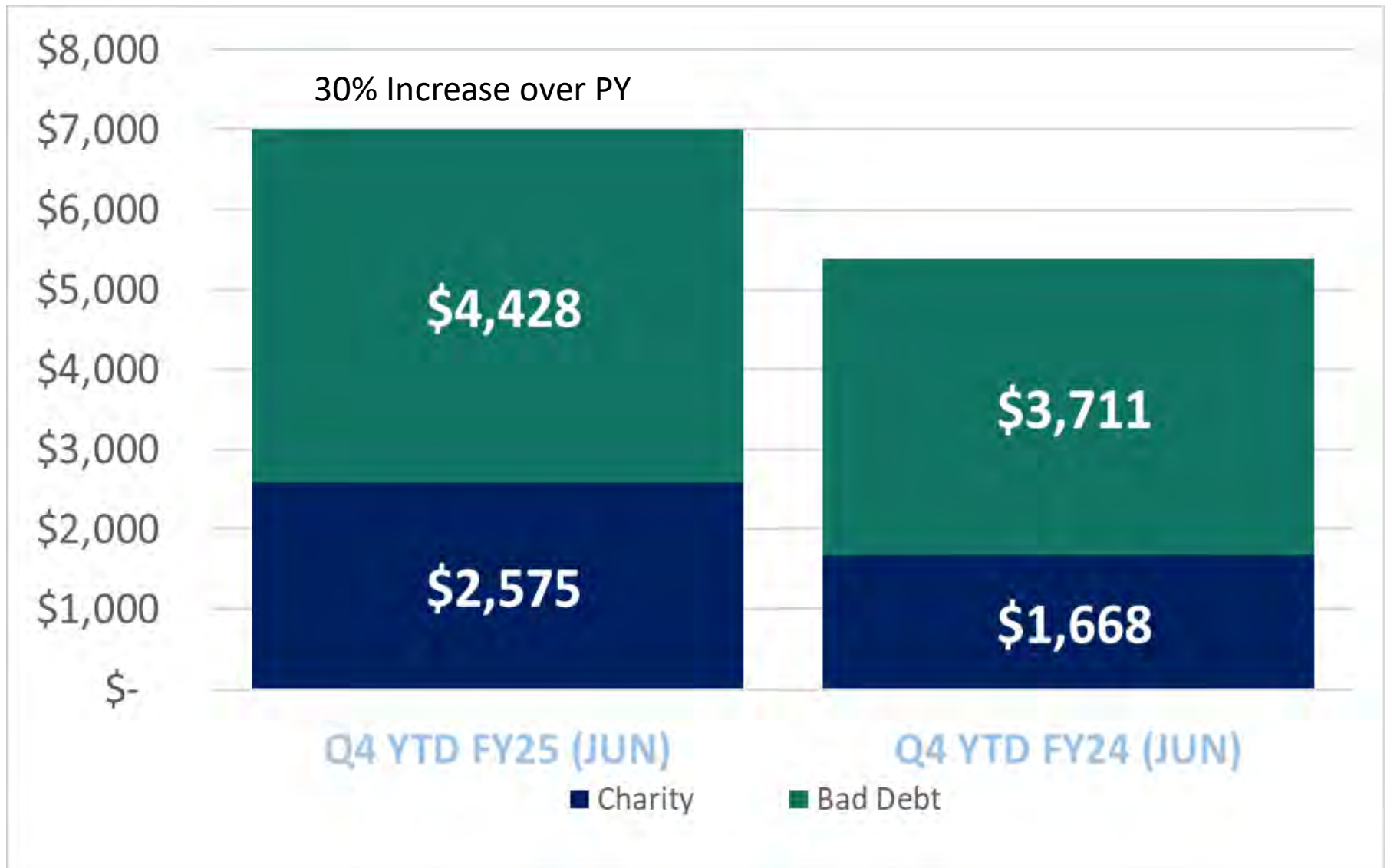

Days Cash on Hand

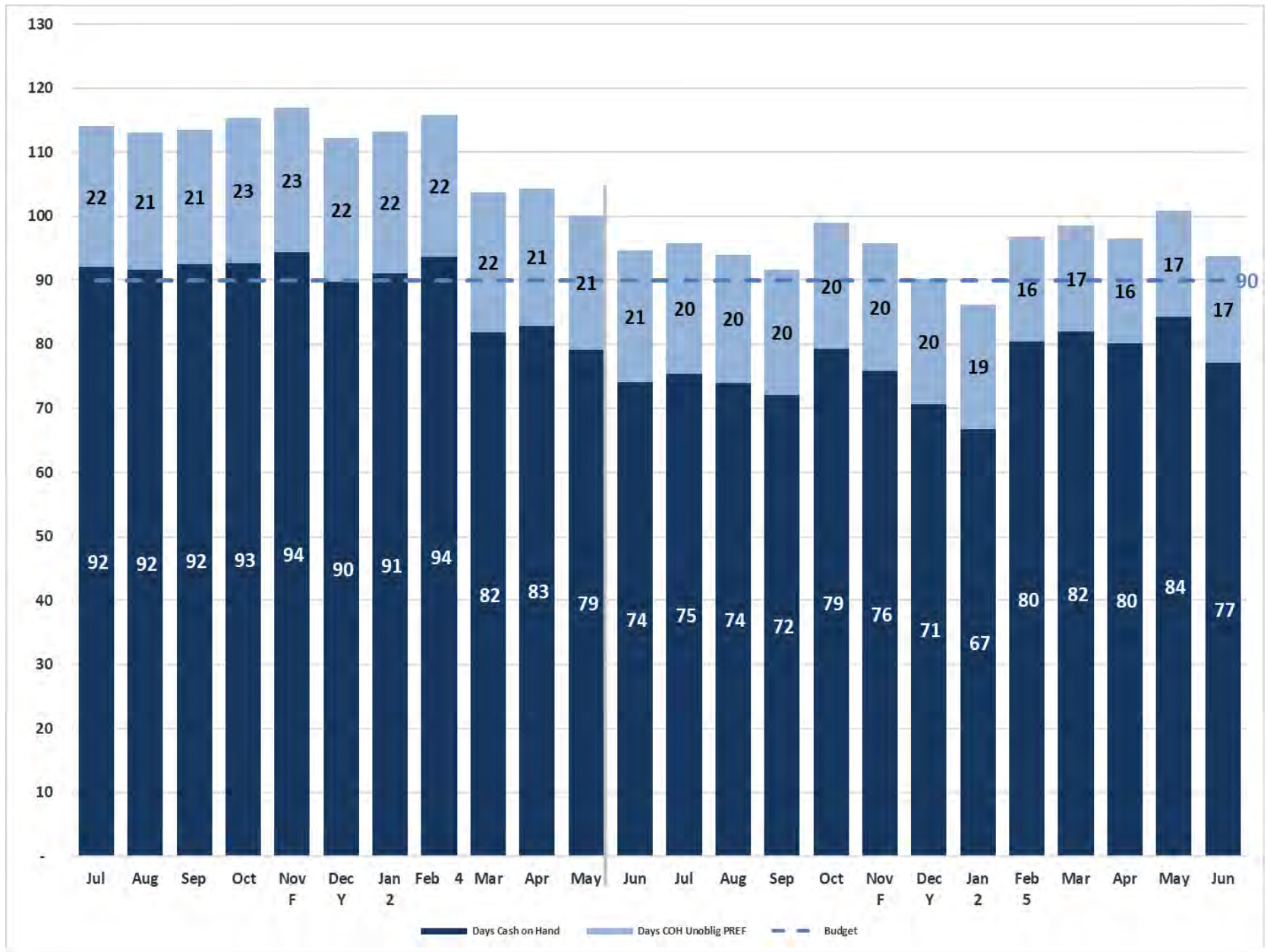

New Providers this Summer



Lauren Dorsey-Spitz, DO – Pediatrics (*Here!*)
Homer Medical Center



Jenna Aird, MD – Dermatology (*July, 2025*)
Renew Plastics & Dermatology Clinic



Gregory Aird, MD – Diagnostic Radiology (*July, 2025*)
Employed Radiologist



**Ian Lawrence, MD – Internal Medicine-Pediatrics
(*September 2025*)**
Hospitalist

New Providers this Summer

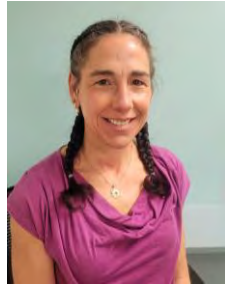

Heather Moon, NP *(Here!)*

Seaworthy Functional Medicine

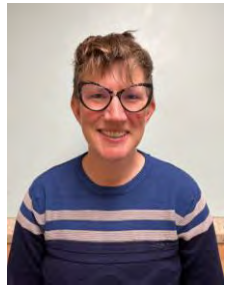

Hayley Walters, PMHNP *(Here!)*

Seaside Women's Care



Edith Jones, PMHNP-BC *(September 2025)*

Serene Waters Behavioral Health

New Providers this Summer



Natalie Hoshaw, MD - OBGYN *(Here!)*

Seaside Women's Care team



Clare Thompson, CNM *(Here!)*

Seaside Women's Care team



Teresa Kirchner, FNP *(September 2025)*

Long Term Care

Follow-up to failed ballot proposition for general obligation bonds

- Community Survey

Now I will read you a list of specifics about the bond. Please tell me your level of support for (read item) do you strongly support, somewhat support, somewhat oppose, or strongly oppose?

■ Strongly support ■ Somewhat support ■ Somewhat oppose ■ Strongly oppose ■ Don't know



84% said they would consider supporting a bond, depending on what it was used for.

- SPH Leadership / Borough planning
- Community conversations

A Strategic Plan for South Peninsula Hospital



How we pay:

- Year - One** FIX SPH - Generator Plant Replacement
\$5 million :: Congressional funds
- Year - Two** FINISH SPH - Complete Shell Space – Pharmacy & Infusion
\$6 million :: Combination PREF and Loans
REAL ESTATE - Purchase Buildings and/or Real Estate \$6 million ::
PREF & Operational Revenue
- Year - Three** BUILD MED OFFICE - Build 25,000 sq/ft Med Office & Urgent Care
\$15 - \$20 million :: General Obligation Bonds

What we say:

- We will ensure sustainability by updating critical infrastructure
- We will improve patient care & experience by consolidating locations
- We will increase access and lower costs by offering urgent care services

Update on a few projects from the Bond Proposition

- Buildings – Strategic Property Review by KPB, continue to lease key properties
- Certificate of Need project - Infusion and Pharmacy relocate to unfinished shelled space
 - Design work continues for Infusion Clinic relocation and pharmacy upgrade
 - Regulatory demands for pharmacy
 - Funding search continues
 - Nuclear Medicine on hold
- Generator / Power Plant
 - \$5 million Congressional discretionary funds
 - Contractor solicitations through July
 - Construction: late 2025 – early 2027
 - Back up in place



Housing Project Update

- Intent: free up 26 leases and streamline efforts
- RFP in fall 2023 for a ten year lease
- numerous proposals



- April 1st 2026 - Phase One Completed (13 Rental Units)
- July 1st 2026 – Phase Two Completed (12 Rental Units)

Housing Project – Location



Housing Project – Site Plan

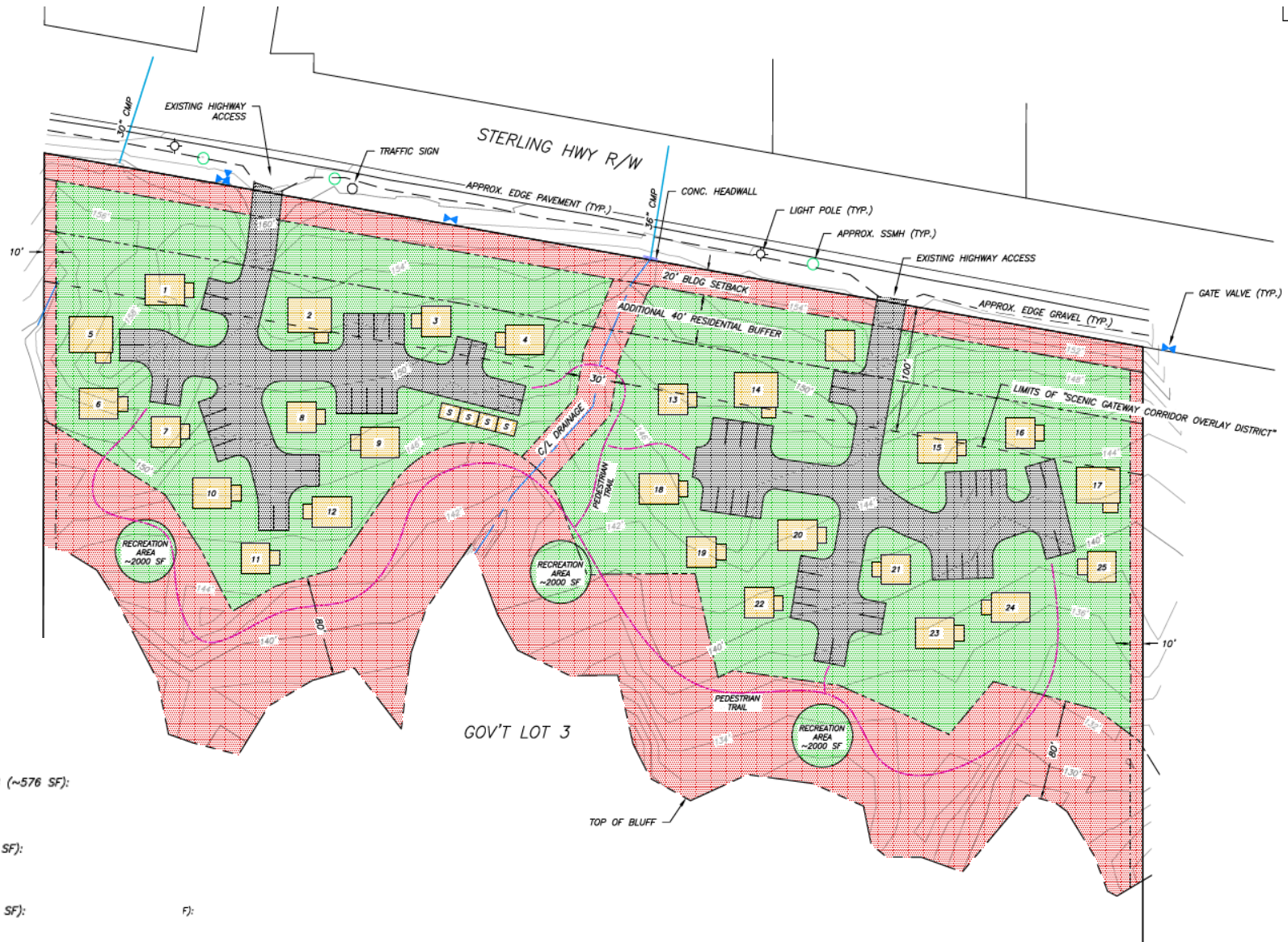

BUILDING FOOTPRINTS

| | |
|--|---|
| | STORAGE (~192): 4 DOUBLE UNITS |
| | MAINTENANCE BUILDING (~576 SF): 1 UNIT |
| | 1 BED 1 BATH (~576 SF): 10 UNITS |
| | 2 BED 1 BATH (~768 SF): 11 UNITS |
| | 3 BED 2 BATH (~1008 SF): 4 UNITS |

F):

Housing Project – Construction Happening!



Childcare Timeline & Next Steps

Now → August:

- Continue staff hiring/training
- Work toward the completion of our center

End of July:

- Release program and tuition info

End of August:

- Open forum for interested families
- Lottery registration opens

Fall 2025:

- Construction finalization
- Licensing process continued

Late 2025:

- Phase 1 Opening
- Ongoing updates to families



New Electronic Health Record – August 2025



It's better for patients

- Equipment and hardware changes in place
- Compatible system upgrades for interoperability
- Training complete
- Transition Dates: August 8th (hospital) and 11th (clinics)
- Parallel systems for a few months

Community Happenings

- Homer Steps Up Success
- Free Friday at Kenai Peninsula Fair (August 8)
- Senior Wellness Day Event in September
- Wellness Wednesdays resume in October
- Rotary Health Fair discount blood draws - October



Recent Achievements

**Long Term Care received the
Silver – Commitment to
Quality Award**



Last year's Bronze Award

2025 Retirements



Laura Miller - 38 years



Donna Rollins - 10 years



Shevawn Miller - 25 years



Bernadette Arsenault - 34 years

Thank you

QUESTIONS?



*South Peninsula Hospital is the healthcare provider of choice,
with a dynamic and dedicated team committed to service excellence.*