



# **KENAI PENINSULA BOROUGH**

PLANNING DEPARTMENT

144 North Binkley Street • Soldotna, Alaska 99669-7520

PHONE: (907) 714-2200 • FAX: (907) 714-2378

Toll-free within the Borough: 1-800-478-4441, Ext. 2200

www.kpb.us

**MIKE NAVARRE**  
**BOROUGH MAYOR**

## MEMORANDUM

TO: Johni Blankenship, Borough Clerk

THRU: Max J. Best, Planning Director *MB*

FROM: Maria E. Sweppy, Planning Specialist *Maria Sweppy*

RE: Captain Steve's Fishing Lodge

DATE: May 9, 2016

As requested, the Planning Department reviewed Captain Steve's Fishing Lodge new liquor license application to determine if churches or schools are within 500 feet (KPB 7.10.020). A 500-foot radius search was done for KPB Parcel 159-520-13, 22780 Shady Drive, Ninilchik.

Churches and schools are shown as institutional on the land use map.

Kenai Peninsula Borough records show no schools or churches within the 500-foot buffer.

Maps and land status information are attached.

Captain Steve's Fishing Lodge  
New Liquor License Application  
Parcels within 500 Feet

**Parcel: 15951001**

Use Code: Residential Cabin - single  
Acreage: 1.84  
HESS DEBRA & MCDONALD GLENN  
2231 MIDDLE TORCH RD  
SUMMERLAND KEY, FL 33042

**Parcel: 15911140**

Use Code: Residential Vacant  
Acreage: 1.50  
GEPHART CLYDE THOMAS Jr  
PO BOX 325  
FORT JONES, CA 96032

**Parcel: 15952011**

Use Code: Residential Accessory Bldg  
Acreage: 3.93  
CARTWRIGHT LOREN D  
37915 RAINBOW DR  
SOLDOTNA, AK 99669

**Parcel: 15911111**

Use Code: Residential Vacant  
Acreage: 160.00  
NINILCHIK NATIVE ASSOCIATION, INC  
PO BOX 39130  
NINILCHIK, AK 99639

**Parcel: 15911133**

Use Code: Residential Accessory Bldg  
Acreage: 5.02  
SMITH STEVEN G & LEANNE M  
PO BOX 39143  
NINILCHIK, AK 99639

**Parcel: 15952002**

Use Code: Residential Vacant  
Acreage: 4.34  
BARRINGTON MATTHEW T  
PO BOX 225  
ELKO, NV 89803

**Parcel: 15952003**

Use Code: Residential Vacant  
Acreage: 5.25  
CARTWRIGHT LOREN D  
37915 RAINBOW DR  
SOLDOTNA, AK 99669

**Parcel: 15952004**

Use Code: Residential Vacant  
Acreage: 3.82  
CARTWRIGHT LOREN D  
37915 RAINBOW DR  
SOLDOTNA, AK 99669

**Parcel: 15952010**

Use Code: Residential Vacant  
Acreage: 2.99  
THURMOND EDWARD Sr  
PO BOX 41  
GALENA, AK 99741

**Parcel: 15952017**

Use Code: Residential Dwelling - single  
Acreage: 2.47  
NELSON DAVID T  
22855 SHADY DR  
NINILCHIK, AK 99639

**Parcel: 15952014**

Use Code: Residential Accessory Bldg  
Acreage: 1.78  
GALLAGHER LARRY J  
5625 N ARM DR  
MOUND, MN 55364

**Parcel: 15952015**

Use Code: Residential Accessory Bldg  
Acreage: 1.94  
FAIRBANKS BEVERLY ANN  
3018 59TH ST S APT 414  
GULFPORT, FL 33707

Captain Steve's Fishing Lodge  
New Liquor License Application  
Parcels within 500 Feet

**Parcel: 15951051**

Use Code: Residential Dwelling - single  
Acreage: 1.80  
WOLFE JAMES L Jr  
PO BOX 9  
CAMAS VALLEY, OR 97416

**Parcel: 15951050**

Use Code: Residential Dwelling - single  
Acreage: 1.80  
RAIGOSA JOSEPH  
PO BOX 39291  
NINILCHIK, AK 99639

**Parcel: 15911141**

Use Code: Residential Improved Land  
Acreage: 3.04  
NOBLE REBECCA REVOCABLE LIVING TRUST  
REBECCA NOBLE, TT  
PO BOX 39285  
NINILCHIK, AK 99639

**Parcel: 15911142**

Use Code: Residential Dwelling - single  
Acreage: 13.14  
SWEGLE EDWARD H  
3930 DOROSHIN AVE  
ANCHORAGE, AK 99516

**Parcel: 15952016**

Use Code: Residential Dwelling - single  
Acreage: 2.01  
OLESON IRVIN R  
HC 78 BOX 8  
REGINA, NM 87046

**Parcel: 15911135**

Use Code: Residential Dwelling - single  
Acreage: 5.00  
NOBLE ROBERT C JR & LORI L  
PO BOX 39522  
NINILCHIK, AK 99639

**Parcel: 15952005**

Use Code: Residential Vacant  
Acreage: 2.95  
HANSEN TORVALD  
PO BOX 1386  
ANCHOR POINT, AK 99556

**Parcel: 15952013**

Use Code: Lodge - Multiple Cabins  
Acreage: 4.25  
SMITH STEVEN G & LEANNE M  
PO BOX 39143  
NINILCHIK, AK 99639

**Parcel: 15952012**

Use Code: Residential Dwelling - single  
Acreage: 3.34  
CARTWRIGHT LOREN D  
37915 RAINBOW DR  
SOLDOTNA, AK 99669

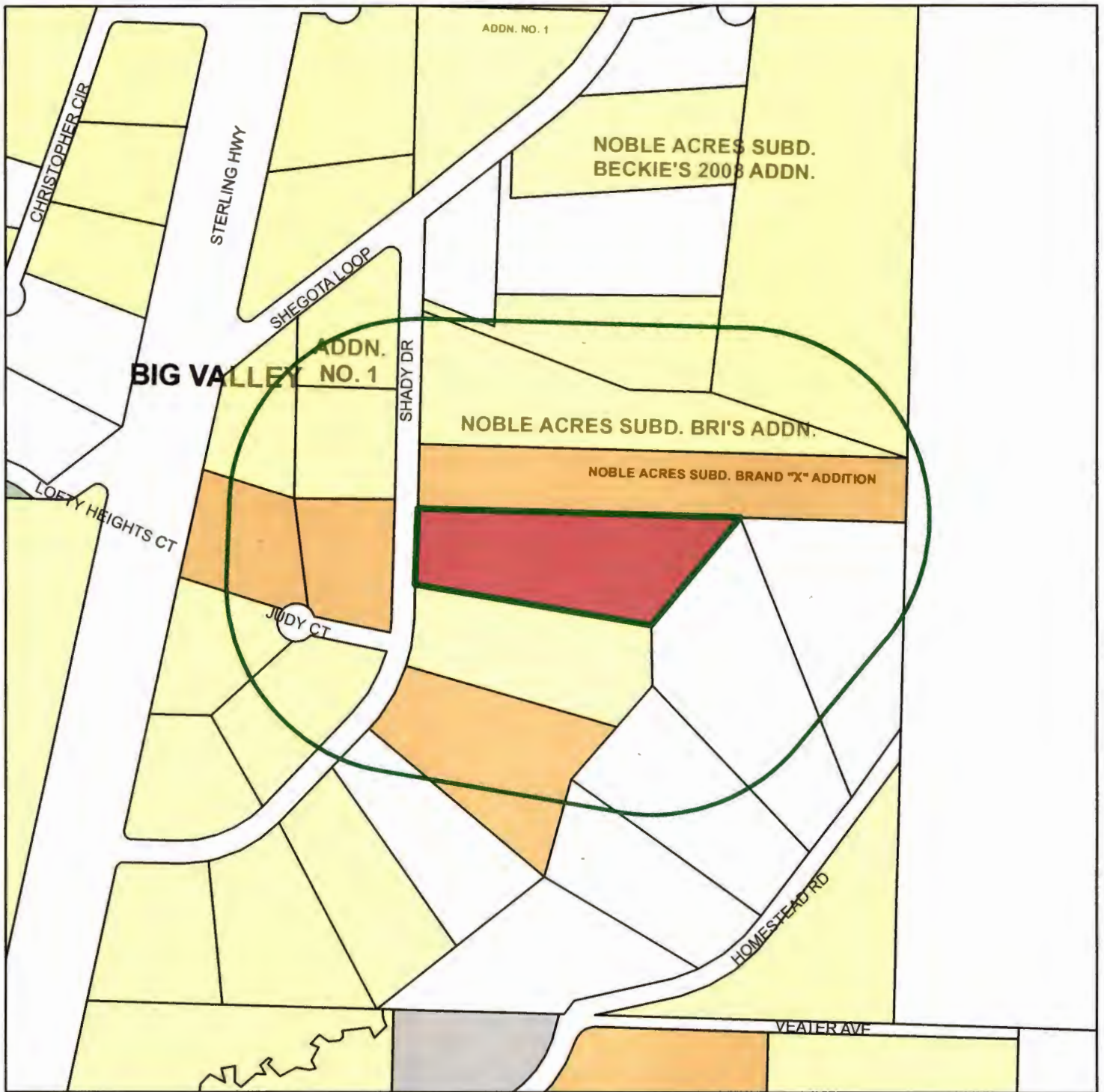

The information depicted hereon is for a graphical representation only of best available sources. The Kenai Peninsula Borough assumes no responsibility for any errors on this map.

**Captain Steve's Fishing Lodge  
New Liquor License Application**

Land Use within 500 Feet

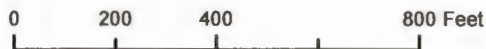

Date: 5/9/2016

**Land Use**

- VACANT
- RESIDENTIAL
- COMMERCIAL
- INSTITUTIONAL
- TIMBER/FARM
- INDUSTRIAL
- ACCESSORY BUILDING



The information depicted hereon is for a graphical representation only of best available sources. The Kenai Peninsula Borough assumes no responsibility for any errors on this map.

Kenai Peninsula Borough Planning Department  
Vicinity Map



Date: 5/9/2016