



CPGH, Inc. Quarterly Report

Prepared for

The Kenai Peninsula Borough
Assembly and Administration

November 22, 2016



- Presentation Items
 - Finance Report
 - 2015 Hospital IP Pricing Comparison
 - Medical Staff Update



Gross Patient Revenue – FY2016

(in thousands)

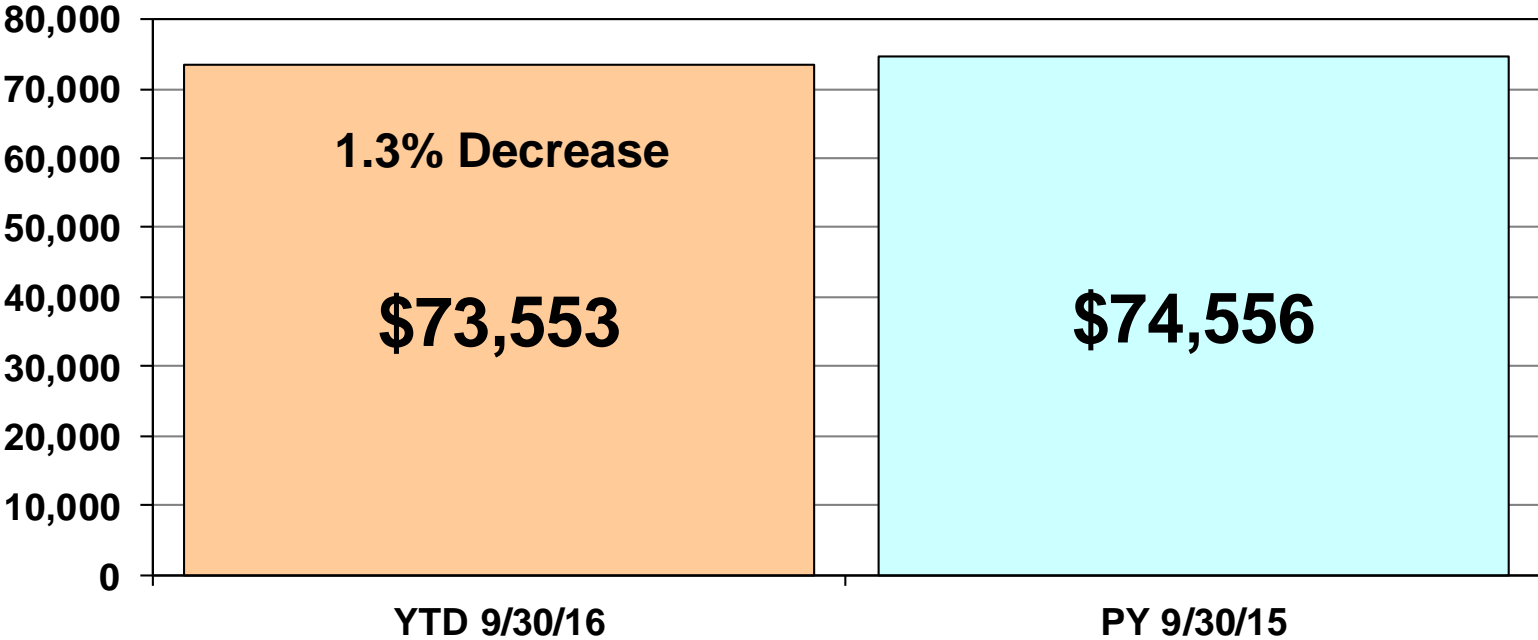

Net Patient Revenue – FY2016

(in thousands)

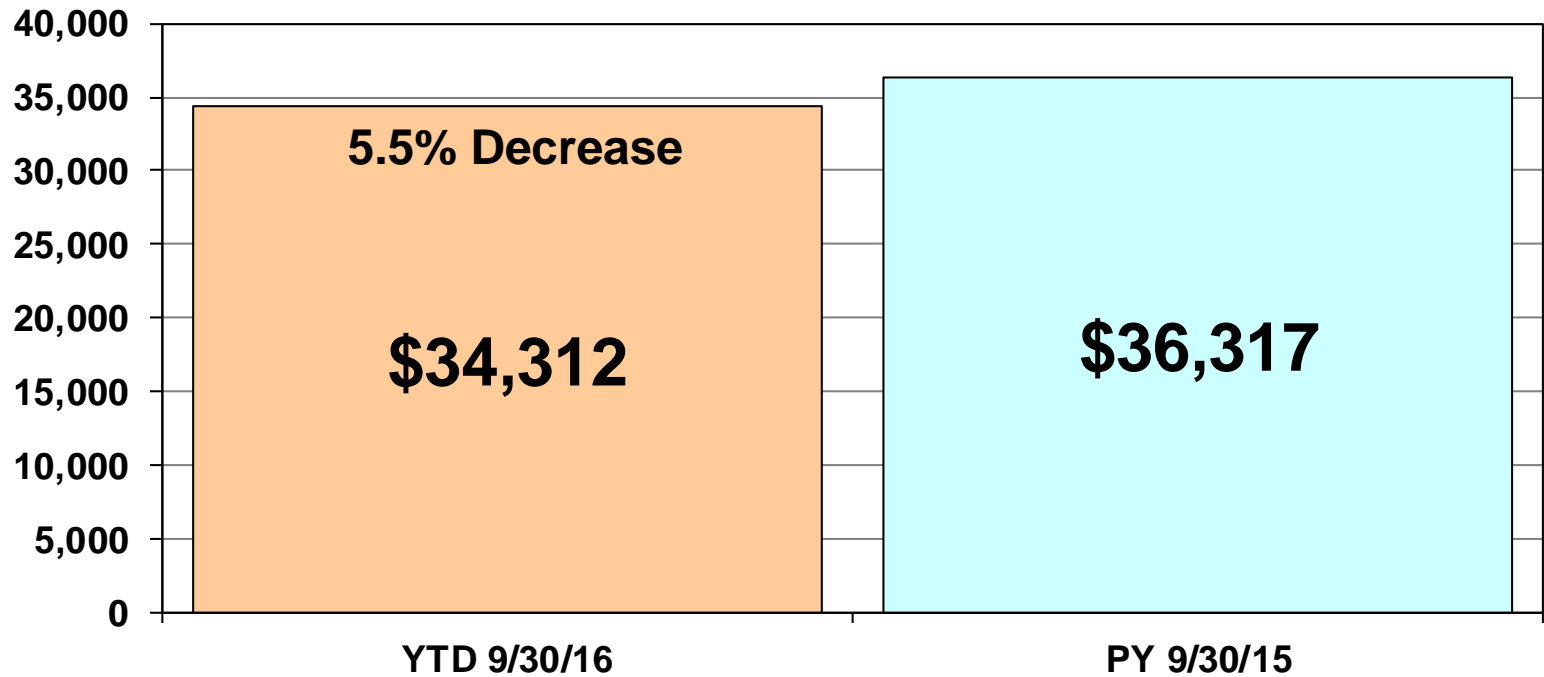

Net Income – FY2016

(in thousands)

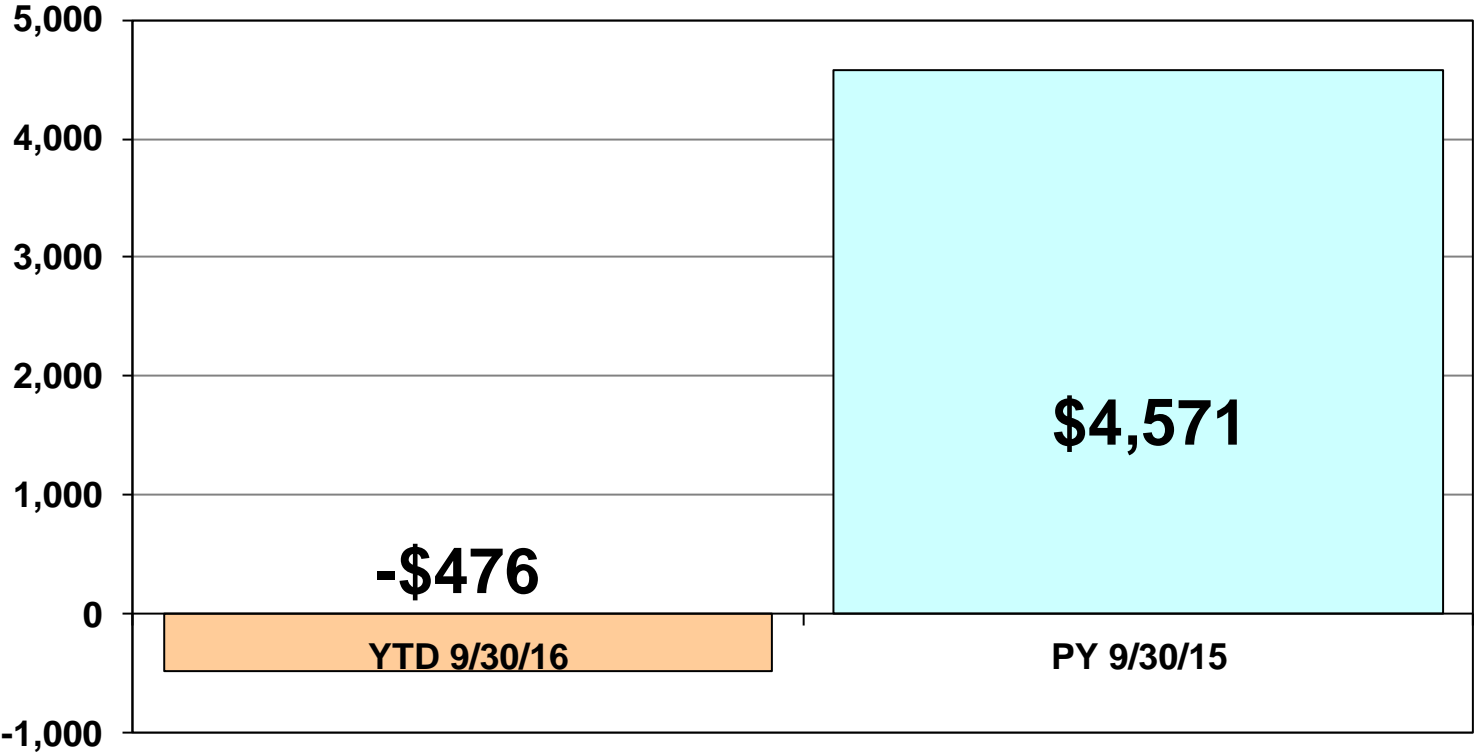

Charity Care & Bad Debt

FY2016

(in thousands)

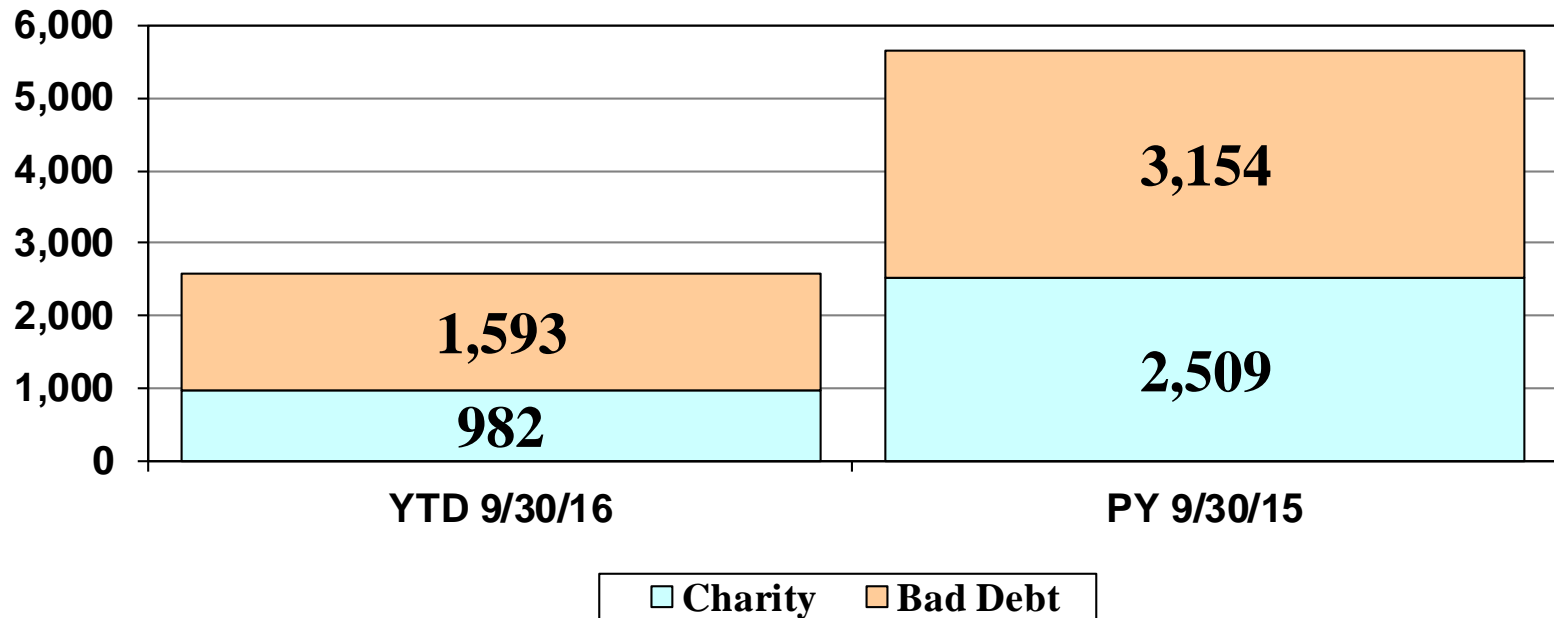

Community Benefit



State-of-the-Art Technology. State-of-the-Heart Care.



Uncompensated Care Trend

(Charity & Bad Debt, in thousands)

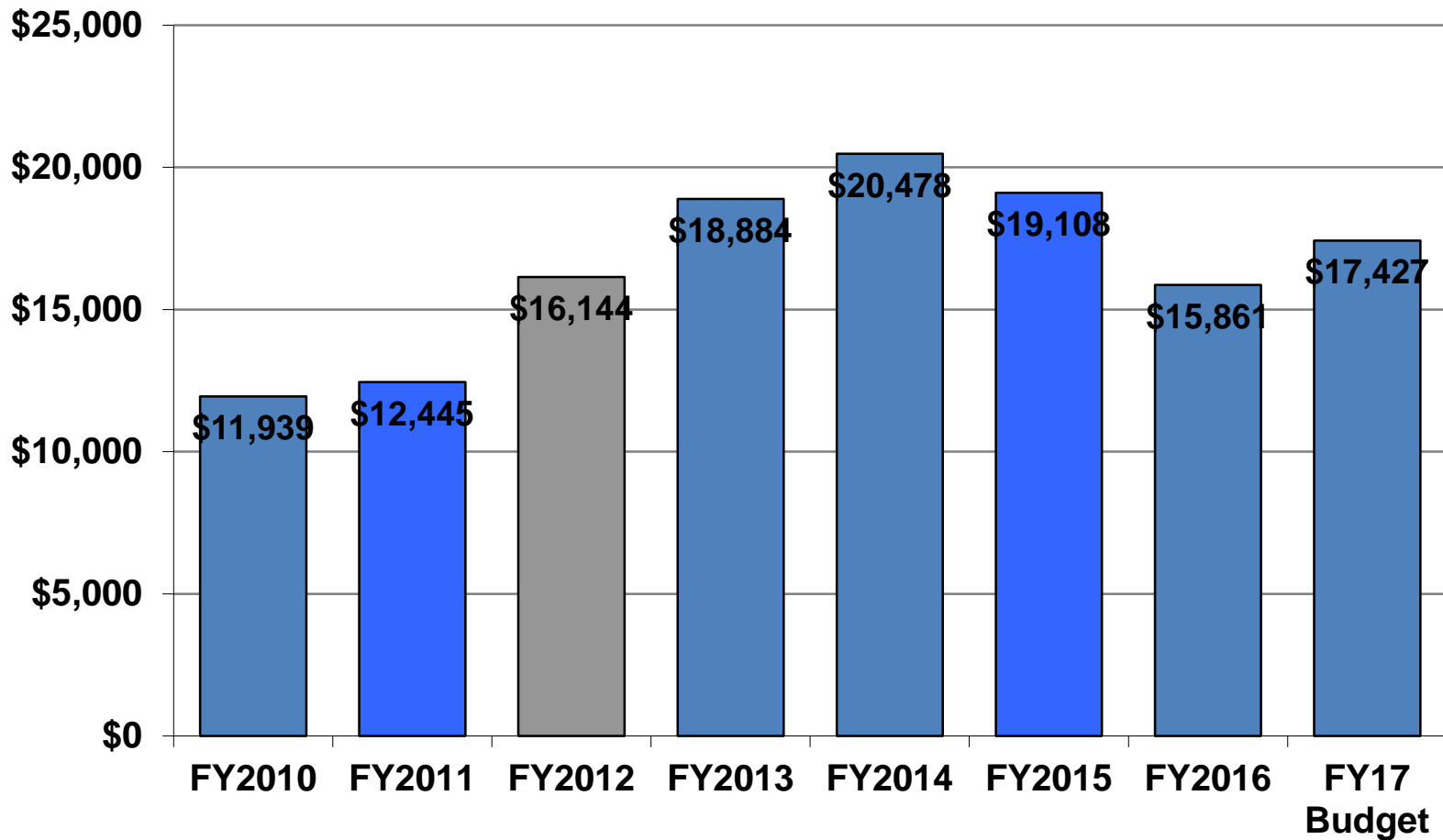

Charity Care & Bad Debt FY 2017

- \$2.6 Million in uncompensated care provided to community members
- Financial Assistance Program Brochure available at the following website
 - <http://www.cpgh.org/workfiles/CPH%20FinancialAssistBrochure-12-10lr.pdf>



Cash & CEs

FY2016

(in thousands)

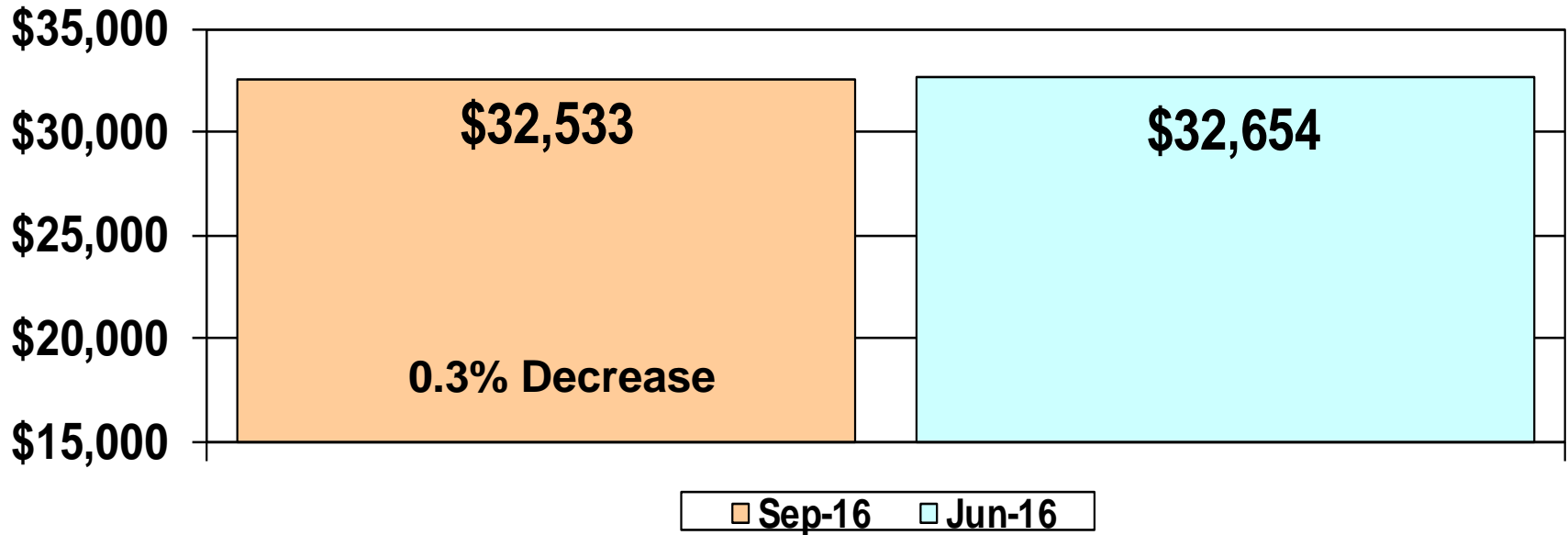

Note: Total of \$1M transferred out of Operating beyond normal business. This includes:

- \$0M in 2011 Refunding Bond Payments
- \$1.03M in 2014/15 Series Bond/Escrow Payments
- \$0M in Cash transfers to Plant Replacement



Transfers to Plant Replacement & Expansion Fund

- PREF Acct. Balance at 9/30/2016: \$31,166,519
(unobligated portion = \$21,343,633)
- Days Operating Cash on Hand at 9/30/2016 –
104.07 days
- Amount pending for transfer as of 9/30/16 –
\$4,476,228



Obstetrics Catheterization Lab

(Phase VI)

- Design Services Bid
 - Out for Bid 11/1/2016
 - Pre-Proposal Conf 11/16/2016
 - Bids Due 12/7/2016
 - Construction Bids 8/2017
- Construction 2017
- Completion 2020
- Thank you for your support!

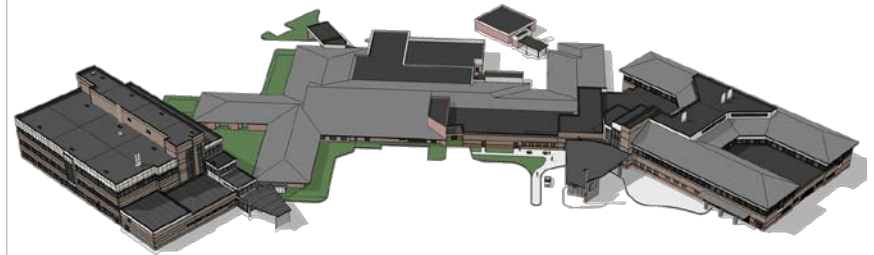

Medical Staff Update

- Gray Allen, MD – Anesthesia
- Christina Lacey, DPM – Surgical Podiatry

