

Kenai Peninsula Borough Planning Commission Meeting, April 10, 2017
Assembly Meeting, April 18, 2017
Recommendation on State Application for Marijuana Establishment License

KPB Parcel ID: 063-104-06
Applicant: Fat Tops, LLC
Property Owner: IBWT Investments LLC

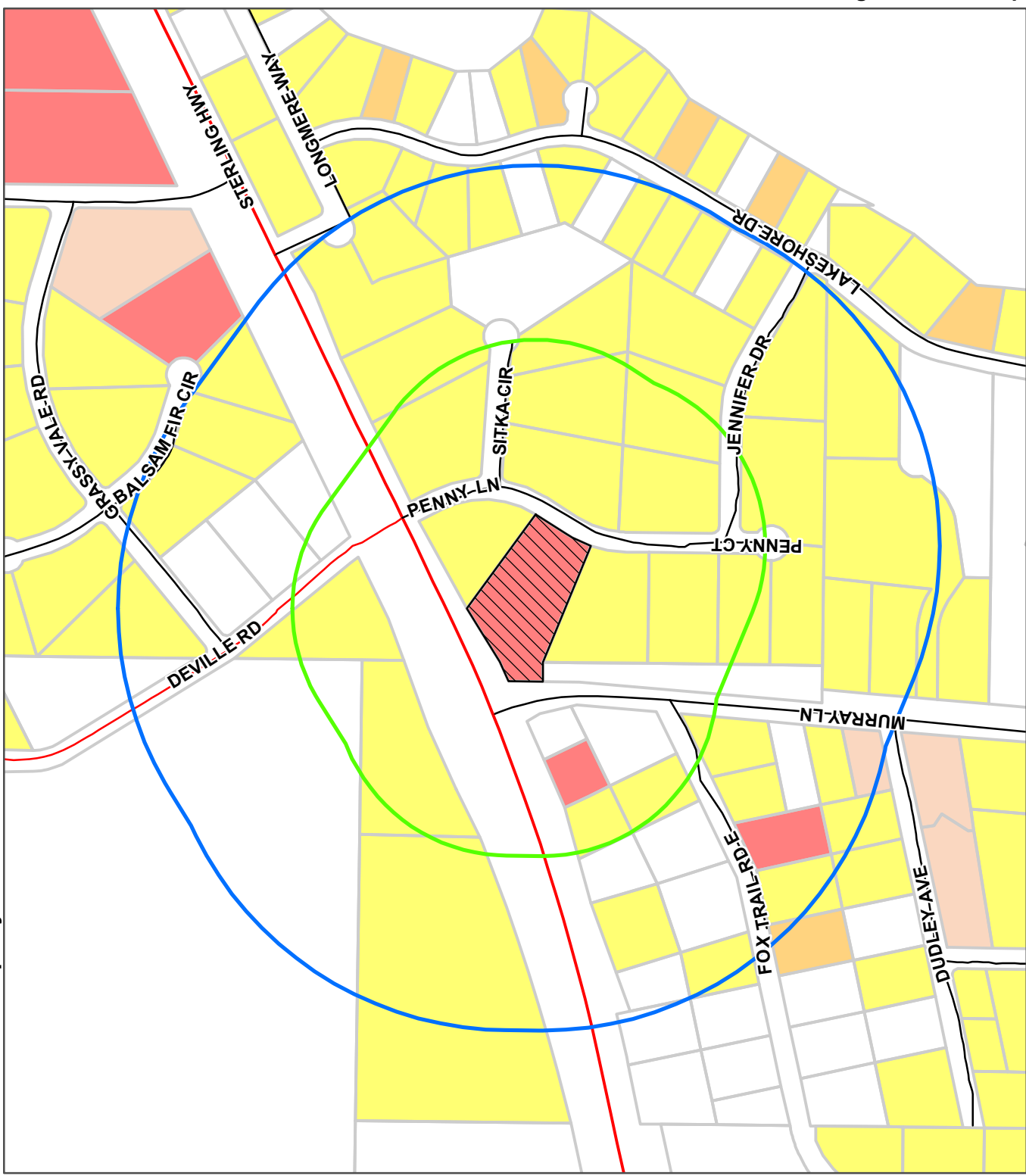
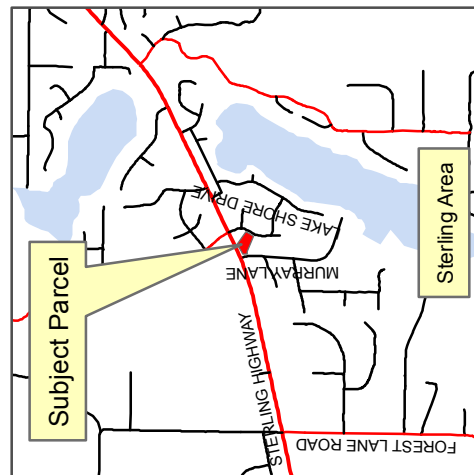

LEGEND

- 1,000-foot Parcel Radius
- 500-foot Parcel Radius
- Subject Property
- Parcel owned by religious organization
- VACANT
- RESIDENTIAL
- COMMERCIAL
- INSTITUTIONAL
- ACCESSORY BUILDING

Radius shown depicts the radius from the parcel boundaries. KPB 7.30 states that the distance must be measured by the shortest pedestrian route. If there were relevant facilities within the 500-foot or 1,000-foot radius, the shortest pedestrian path would be shown and measured.



0 250 500 Feet

Date: 3/16/2017

The information depicted hereon is a graphical representation only of best available sources. The Kenai Peninsula Borough assumes no responsibility for any errors on this map.