

TOWNSHIP 5 NORTH, RANGE II WEST, OF THE SEWARD MERIDIAN, ALASKA

SUPPLEMENTAL PLAT

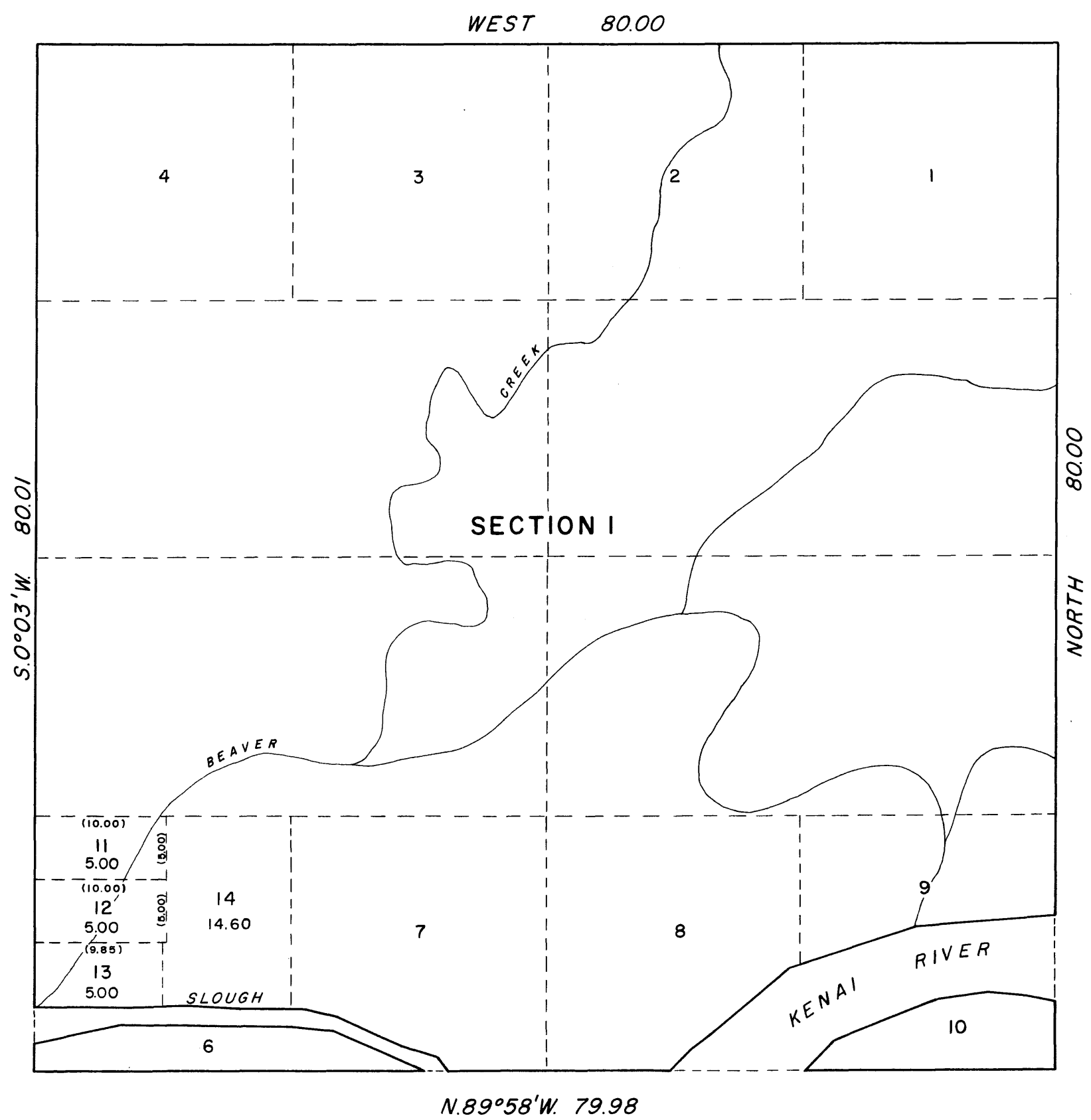

N.89°58'W. 79.98

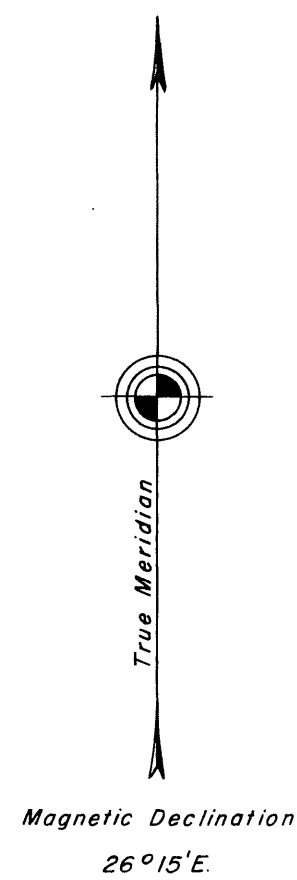
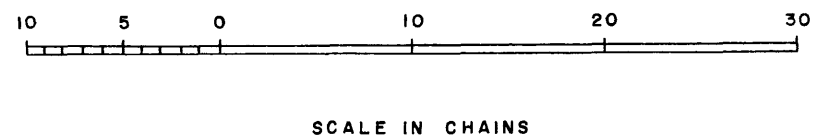

This supplemental plat, showing a subdivision of original lot 5, sec. 1, T. 5 N., R. 11 W., Seward Meridian, Alaska, is based upon the township plat accepted June 13, 1923.

UNITED STATES DEPARTMENT OF THE INTERIOR
BUREAU OF LAND MANAGEMENT
Washington, D.C. May 5, 1961

This plat, showing amended lottings, is based upon the official records, and having been correctly prepared in accordance with the regulations, is hereby accepted.

For the Director

Donald O. Clement

Cadastral Engineering Staff Officer