

**CERTIFICATE OF OWNERSHIP**  
 I HEREBY CERTIFY THAT I AM THE OWNER OF THE PROPERTY SHOWN AND DESCRIBED HEREON. I HEREBY REQUEST APPROVAL OF THIS PLAT SHOWING SUCH EASEMENTS FOR PUBLIC UTILITIES AND ROADWAYS DEDICATED BY ME FOR PUBLIC USE.  
 Randel L. Jones  
 RANDOL L. JONES SRA BOX 49 HOMER, AK 99603  
 Linda L. Jones  
 LINDA L. JONES BY RANDOL L. JONES, TRUSTEE

Cecil R. Jones for Joe M. Jones  
 CECEL R. JONES JOE M. JONES  
 Troy A. Jones Helen Loosli  
 TROY A. JONES HELEN LOOSLI

**NOTARY PUBLIC**  
 NOTARIAL ACKNOWLEDGMENT  
 SUBSCRIBED AND SWORN TO BEFORE ME THIS 13th day of July 1981  
 My Commission Expires June 25th 1984  
 JERRY ANDERSON  
 TROY A. JONES, CECEL R. JONES, JOE M. JONES, TROY A. JONES AND HELEN LOOSLI PERSONALLY APPEARED BEFORE ME ON THE ABOVE SHOWN DATE.  
 Sherry Ann Wilson  
 Notary Public

**SURVEYOR'S CERTIFICATE**  
 I, THE UNDERSIGNED REGISTERED SURVEYOR, HEREBY CERTIFY THAT A LAND SURVEY HAS BEEN COMPLETED BY ME OR UNDER MY DIRECT SUPERVISION AND THAT CORNERS AND MONUMENTS HAVE BEEN LOCATED.  
 Jerry Anderson, RLS 3686-S  
 DATE 7/13/81

**PLAT APPROVAL**  
 THIS PLAT WAS APPROVED BY THE KENAI PENINSULA BOROUGH PLANNING COMMISSION AT THE MEETING OF June 3, 1981  
 KENAI PENINSULA BOROUGH

BY Frank S. Liza  
 AUTHORIZED OFFICIAL

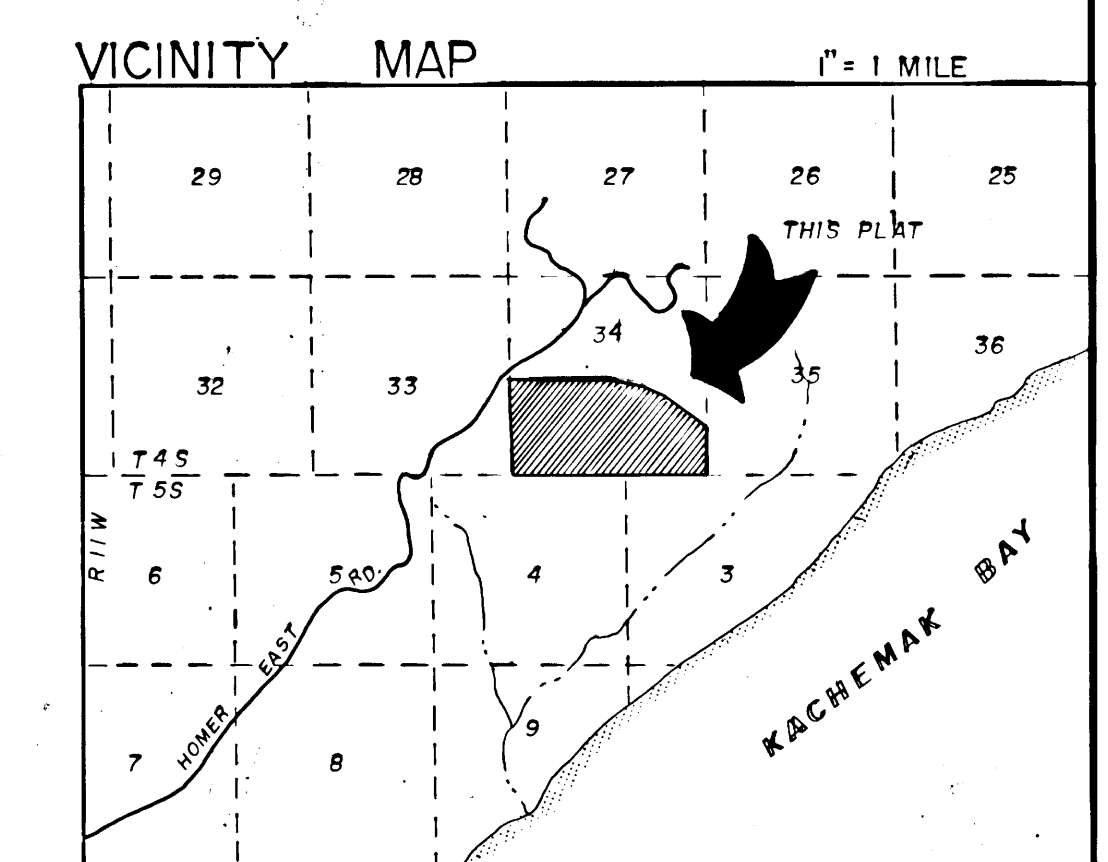

- NOTES:**
1. NO MONUMENTS WERE FOUND OR SET EXCEPT AS SHOWN.
  2. A SETBACK OF 20' IS REQUIRED FROM ALL STREET RIGHTS-OF-WAY UNLESS A LESSER STANDARD IS APPROVED BY RESOLUTION OF THE APPROPRIATE PLANNING COMMISSION, OR UNLESS SHOWN OTHERWISE.
  3. THERE IS A 10' UTILITY EASEMENT ALONG EACH SIDE OF EXISTING POWERLINES.

81-84  
 FILED 10-  
 REC. DIST.  
 DATE 11-10-81  
 TIME 10:00 A.  
 Permitted by  
 Address

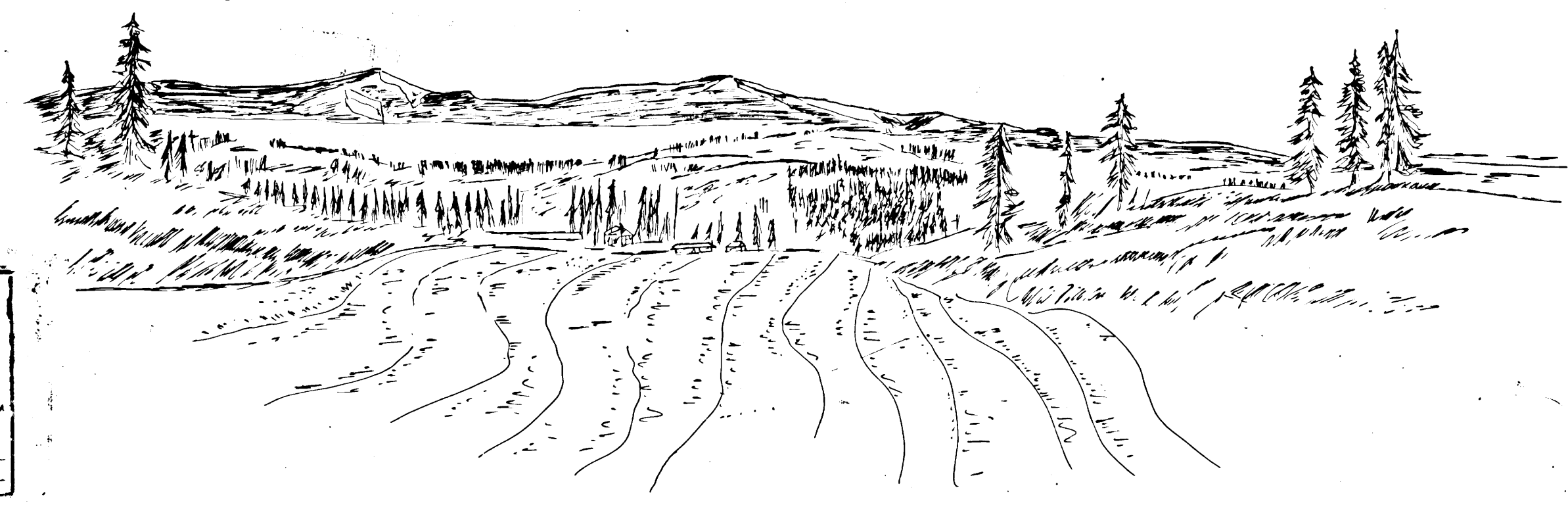

DATE: MAY, 1981  
 SCALE: 1" = 200'  
 DESIGNED BY: J.A.  
 DRAWN BY: S.W.  
 JOB NO.: 1288  
 FLD. BK. NO.: 83-A



**STANLEY'S MEADOW NO. 3**  
 SITUATED IN THE S 1/2, SEC. 34, T 4 S, R 1 W, S.M.  
 AND BEING A RESUBDIVISION OF A PORTION OF ASLS  
 NO. 79-225  
 CONTAINING 287.847 ACRES

ABILITY SURVEYS  
 JERRY ANDERSON, RLS BOX 1263 HOMER, ALASKA